

5 ST MARY'S WALK LOT 14D, SECTION C – CROWN GRANTS 265, 406 AND 523

On 30 September 1884 Crown Grant 265 being Lot 14d in Section C containing one rood was issued to **William ATKINS** for £30. The plot was bounded on north by Crown Land (Court House yard and garden) 92 links, on the south by Crown lands 92 links, on the west by land belonging to F Newman 269 links, on the east by land belonging to the Revd J Foran 269 links.

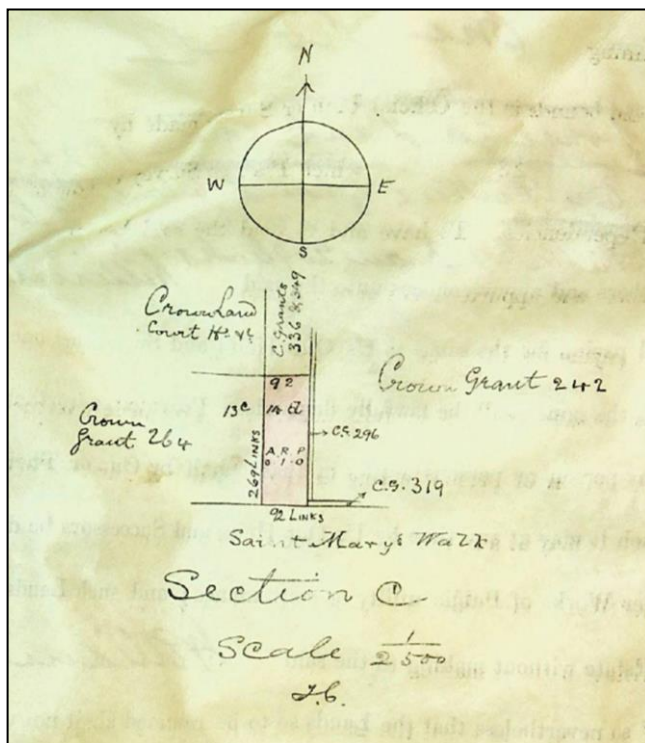

[CG 265]

On 4 July 1893 **William ATKINS**, shepherd of Shallow Bay, granted to **James Charles ROBINS**, engineer of Stanley, Lot D, Section 14 containing one rood and bounded “on the north by land formerly Court house yard and garden in the possession of the Crown but now in possession of the Stanley Assembly Room Company 92 links; on the south by Crown land – a public road 92 links; on the west by land belonging to F Newman 269 links; on the east by land formerly belonging to the Reverend J Foran and now in possession of William Wickham Bertrand Esq 269 links” for £45. [BUG-REG-5; 10]

On 15 August 1894 **James Charles ROBINS** granted to the **Stanley Assembly Room Company Ltd** Lot D, Section C No 14 containing one rood and bounded “on the North by Land formerly Court House Yard and Garden in the possession of the Crown but now in possession of the Stanley Assembly Room Company Limited 92 links, on the South by Crown Land a Public Road 92 links on the West by land belonging to F Newman 269 links on the East by land formerly belonging to the Reverend J Foran and now in possession of William Wickham Bertrand Esq 269 links” for £40. [BUG-REG-5; 43]

On 14 June 1904, on the Government undertaking to maintain a public right of way on the East side of the Assembly Room from Saint Mary's Walk to the Sea, the **Stanley Assembly Room Company Ltd** granted to the **Falkland Islands Government** a strip of land 9 links wide on the East side of their lots numbered Lot D Section C No 14 Crown Grant No 265 and bounded “on the north by land in the possession of the Stanley Assembly Room Company Limited 9 links on the East by land held by Alexander Lee Kiddle 280 links, on the South by St Mary's Walk 9 links on the West by land in the holding of the Stanley Assembly Room Limited 280 links.”

Crown Grant 265, 336, 349
From Lot 14d S C CG 265 – 269 links x 9 links
From Lot 6d S C CG 336 – 1 link x 9 links
From Lot 1d S C CG 349 – 10 links x 9 links
Total 280

[BUG-REG-5; 98]

On 27 September 1911 the **Stanley Assembly Room Company Ltd** granted to the **Falkland Islands Government** Lots 6a Section C, 6B Section C and Lot 14D Section C containing 1 rood 28 310/625 perches or thereabouts, together with the Peat shed and flooring thereon bounded "On the North by a Public roadway and land of the Crown. On the South by a Public roadway (St Mary's Walk). On the West by lot No 13C Sect:C and by land of the Crown. On the East by a Public roadway and by Lots 15 and 16 Sect: C" for £54-6-6. - Crown Grants 265, 336, 349, 361 [BUG-REG-8; 64]

On 17 June 1924 **Gordon Leslie CHALLEN** applied to the **Falkland Islands Government** to be allowed to purchase the corrugated iron timber framed building situated at Navy Point and formerly used as part of the Quarantine Station for £70 as it stood and including the two small outbuildings belonging to it. He was living in the building at the time. The sale was approved 9 August 1924 and the purchase price was paid 30 August 1924. [DEF/NCA/1#10]

On 8 September 1924 **Gordon Leslie CHALLEN** applied to the **Falkland Islands Government** to purchase the building site directly behind Cable Cottage. The land had to go to public auction so he was granted temporary occupation of Cable Cottage while waiting for the sale. He was also given the use of enough of the Customs Shed for the temporary storage of his house. [BUS/JAM/1#4]

In an agreement dated 27 September 1924 the **Falkland Islands Government** granted **Gordon Leslie CHALLEN** permission to erect a dwelling house on the plot of land containing 30 perches more or less situated to the south of Cable Cottage and if he completed three years satisfactory service with the Government from the 1st of September instant the sanction of the Secretary of State for the Colonies will be sought to enable the said Gordon Challen to purchase the site herein referred to for the reserve price set upon town land in Stanley, namely at the rate of £100 an acre.

On 20 January 1928 Crown Grant 406 being part of Lot 14d in Section C containing 30.06 perches more or less was issued to **Gordon Leslie CHALLEN** for £18. The plot was bounded on the north by pathway 11 feet wide adjoining south boundary of Cable Station House 71 links, on the west by lot 13c Section C 2 chains 65 links, on the south by St Mary's Walk 71 links, on the east by roadway 13 feet wide 2 chains 65 links. [CG 406]

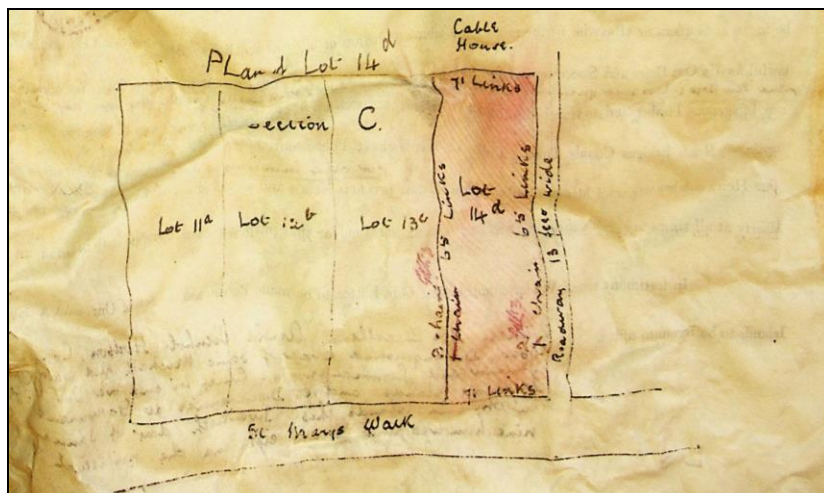

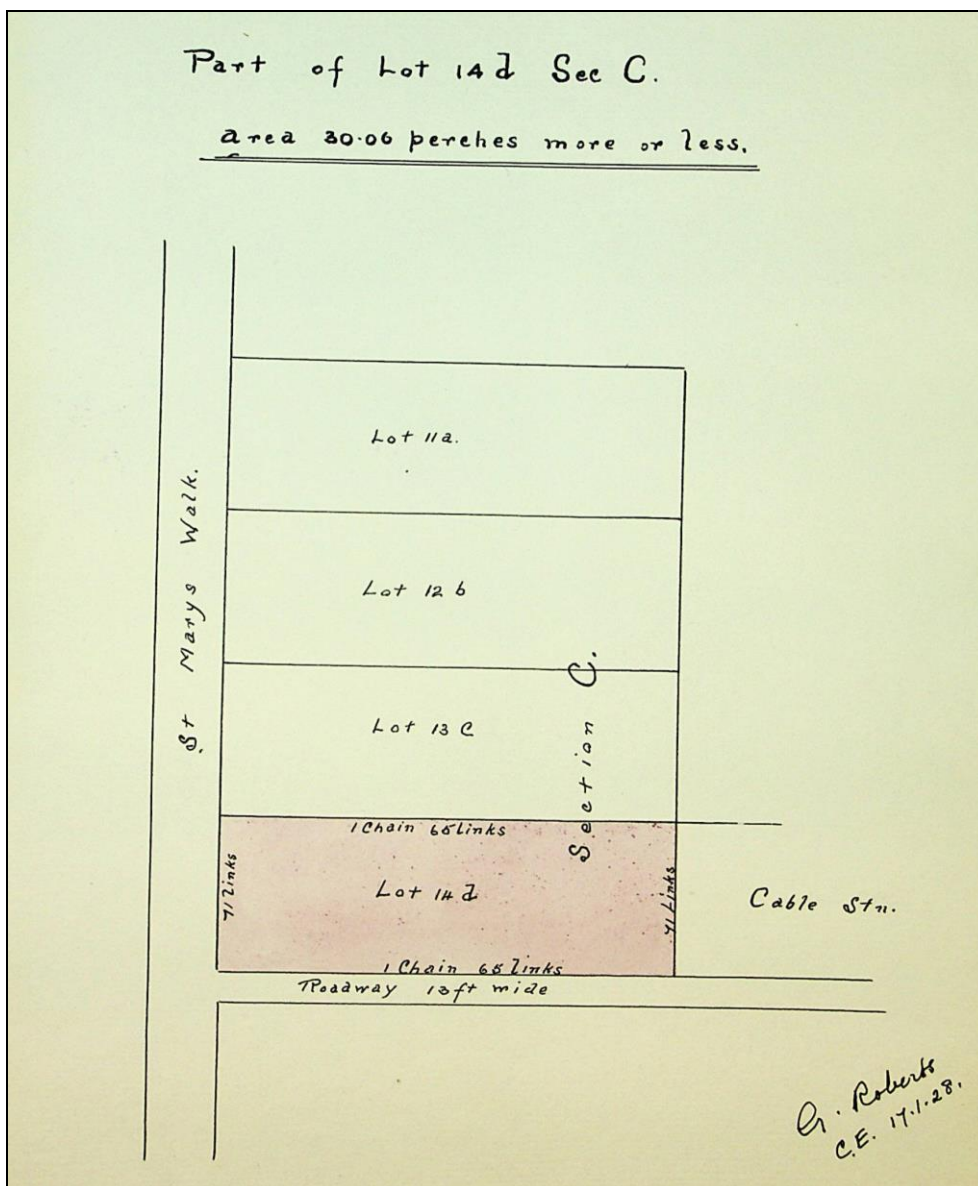

Crown Grant 406 was sent to him 20 January 1928. [BUS/JAM/1#4: BUG-REG-9; 223]

On 2 February 1929 **Gordon Leslie CHALLEN**, of Stanley, granted to **Stephen Charles ALDRIDGE**, of Stanley, the parcel of land with all erections thereon bounded "on the North by pathway 11 feet wide adjoining South boundary of Cable Station House, 71 Links on the West by Lot 13C Section C, 2 chains 65 links on the South by St Mary's Walk 71 links on the East by roadway 13 feet wide 65 links" for £750. [BUG-REG-9; 394]

On 8 January 1951 **Stephen Charles ALDRIDGE** applied to the **Falkland Islands Government** to either lease or purchase the narrow strip of land between the northern boundary of his premises and the southern boundary of Cable Cottage. The land was formerly a back entrance to the Printing Office and the Secretariat but when the new Secretariat was built it was closed up and had only been used for the grazing of his horse during the summer. The land was leased to him for five years from 1 March 1951 at an annual rental of 10/-.

On 8 March 1851 an application by **Stephen Charles ALDRIDGE** to erect a garage on the land was approved.

The lease was renewed for a further three years with effect from 1 March 1956.

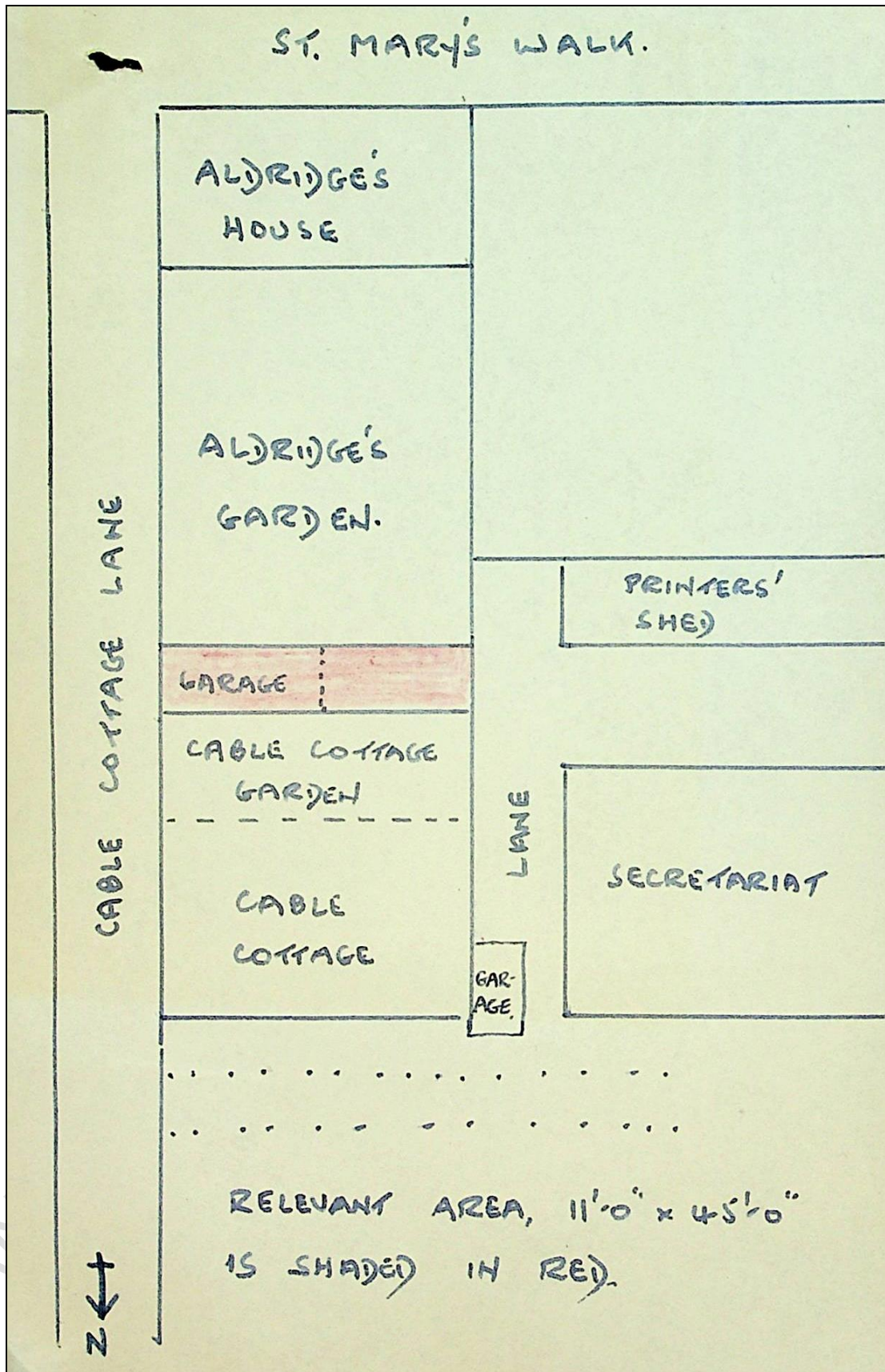

In the meeting of Executive Council held 18 September 1958 it was agreed to sell the land to **Stephen Charles ALDRIDGE** for £5. Crown Grant 523 was sent to him 24 February 1959. [BUS/JAM/1#19]



5 St Mary's Walk from the south December 2020 - JCNA



5 St Mary's Walk from the south-east December 2020 - JCNA