

C.S.

LIVE STOCK
(Common)
No. <b>709/24</b>

1924.

*C.E. 'C'*

Stock Commissioner

SUBJECT.

1924

4th November

Previous Paper.

Report by Mr. H. Munro on improvement of grazing areas of the Common.

200/23

MINUTES.

*Report by Mr. H. Munro of 14th Nov 1924 — Encl ①*

*Attach pt. 11 plan of Peninsula farm*

*B.W. 4/11/24*  
*B.W. 11/3/25*  
*B.L. 14/3/25*  
*P.A. 14/3/25*  
*3 April 24*

*Y.S. Submitted.*

*This report should be useful. I would suggest that it might be published in the Gazette with an intimation that the Government is prepared to consider any representations that may be made by any party likely to be affected, as it is proposed to ~~carry out~~ <sup>give effect to the recommendations</sup> generally. In the meantime the Chief Inspector of Stock might be asked to consider the matter and to suggest the best lines for the fences to run.*

*15 Nov. 24  
20 Nov. 1924*

Subsequent Paper.



Printed report vide page 136 of Dec 1924  
Gazette.

(2)

Chief Inspector of Stock  
Copy of reports herewith.

Chief Inspector of Stock

As necessary a/c this please

1/12/25

The Secy

Chief Secy.

I shall submit a plan  
of required fencing immediately after  
I have thoroughly inspected  
the Common

T. A. Curtis

Chief Insp. of Stock  
1/12/25

B.M. 6 St.

Chief Inspector of Stock

Mr. J. McNeill the Comr has  
represented that the Peninsula cannot  
carry cattle past experiments having failed.  
I have not his letter at hand now but  
the point is worth careful examination.



The Peninsula soil is certainly light and sandy as you know and it is I believe agreed that the destruction of the greater part of it - extending to the light house was due to the work of cattle

~~16~~ 16 March 25

The Hon.

Col Sec.

This matter will receive my earliest attention & I will take the first opportunity to inspect the whole of the Peninsula

Red Carter

20/3/25

Chf Insp of Stock

Chief Inspector of Stock

Will you please say what has been done with regard to this matter.

W.C.B.  
for C.S.  
6th Oct 1926

The Hon

Col Sec.

I have inspected the Peninsula & am of the same opinion as Mr Gill that the Peninsula land is not suitable



for the grazing of cattle

Regarding the fencing of  
the Common, I should like to  
again go over this ground before  
submitting my recommendations

Ted Carter

P. S.

14/10/26.

1. I regret that there has been a

regrettable delay in dealing with this matter.

2. The Chief Inspector of Stock should  
submit his report and recommendations as to  
the required fencing by 1. 11. 26.

JMS

22. 10. 26.

JMS  
22 Oct. 1926

Chief Inspector of Stock

For action accordingly, please.

JMS  
C. W. S.

22. 10. 26.



Inside Minute Paper.

The Hon  
Col Sec.

I would like to know  
if I could have the assistance of two  
P.W.D. men for one day to measure  
the fence lines I will be glad

1 to Carter  
O. L. S.  
25/10/26

Early

Clerk & P.O. Dept.

Can this be arranged, please?

J. Muller  
O. L. S.

25.10.26

Hon, Col, Secretary.

This matter can be arranged to  
suit Mr Carter's convenience.

E. H. Bound.  
Clerk-in-Charge P.W.D.

25th October, 1926.

Chief Inspector of Stock.

Please see.

J. Muller

O. L. S.

26.10.26



The Hon  
Col Sec.

Thank you Dear

T. W. Carter C. I. S.  
26/10/26

1. 11. 26

26. 10. 26

Chief Inspector of Stab.

Your report is now due, please.

W. Carter

1. 11. 26.

G. L. Sec

The Hon  
Col Sec

I have again inspected the Common  
& although it is a little too early to observe the  
best grass growing portions the area as marked  
on attached chart will I believe be the most  
suitable for the grazing of milking cows. See Encl 2.

The line marked A.B. is approx.  
1 1/2 miles & by erecting a fence along this line  
a considerable portion of good grazing  
ground to the west of this line will be fenced off.

This area ~~is~~ is within a  
reasonable distance of the town & as at present  
most of the animals graze upon it it will  
if fenced off & used only for cows actually  
milking (or cows about to calve) provide a good  
deal more grass & thereby increase the Stanley  
milk supply.

I should like to know if the area <sup>E</sup>  
if fenced off would interfere with the post banks.

T. W. Carter  
C. I. S.

2/11/26.



Col Pyrie

For your observation - please -  
 note particularly from the point of  
 view of peat end of finance.

J. M. L. S.  
 G. Col. Sec.

4. 11. 26.

The Hon. Col. Secy.,

I regret the delay in answering this

paper.

2. Should the fence be erected as shown gates would require to be placed at positions convenient for the peat carters. Otherwise the fence would not interfere with the peat supply.

3. The length of fencing would appear to be about two miles. The cost will depend on the class of fence to be erected. If a six wire fence were erected, with an average distance of 16 yards between the posts, the cost would be about £100 per mile, giving an estimated total cost of £200 for the work. The unallocated balance under Head XIX., item 3, Fencing Crown Lands, is at present £96.

P. M. Basely.

Colonial Engineer.

30th March, 1927.

Spoke W. J. H. 31.3.27.

4. 12. 27.

re 31. 3. 27.



Off. No. Post.

1. I have seen W. McMillan in this connection  
at home this morning discussed the matter with  
the Chief Inspector of Dept.

2. It is stated that the position of  
the holding paddock marked "E" on the plan  
will cause considerable inconvenience to the owners of  
milky cows in Stanley. W. Carter is going to  
investigate on the spot and in consultation with W.  
McMillan the possibility of an alternative situation.

3. W. Carter is also considering the questions  
of a reserved area for "coming-on" cows i.e. cows  
due to calve in a period not exceeding three weeks  
and of special facilities for working horses i.e. horses used  
for the carting of peat etc. as opposed to riding horses  
kept for occasional use or for pleasure.

4. Please refer to C.I. of Dept. for action  
and report accordingly.

J.M.

28.4.27



C.S.O. No. 709/27

Inside Minute Paper.

Sheet No. 5

Chief Inspector of Stock,

Referred to you for necessary  
action and report.

W. J. C. S.  
28 April 1927

P. 1/0 Sect.

I shall see Mr McGill &  
go over the ground in question with him  
I shall then furnish the necessary  
report.

The Carter  
C. J. S.  
29/4/27

Chief Inspector of Stock.

For report please

W. J. C. S.

W. J. C. S.

18. 6. 27

The Chief Sec

I have not yet been able  
to go over the ground with Mr McGill  
but I shall be able to submit  
a report this week

The Carter  
C. J. S.  
21/6/27



Chief Inspector of Stock.

This matter should be  
expedited as much as possible -

2. It will be necessary for  
me to take serious notice of any  
further delay.

J. M. Kelly  
C. J. Kelly

21. 6. 27

The Hon  
C. J. Kelly

I have gone into the matter of  
pacing on the common with Mr. Kelly  
who knows all the common ground well

2 Mr. Kelly agrees with me  
that the pacing as proposed in Encl. 2  
are on suitable lines

3 The paddock marked E  
was suggested by me as being a  
suitable paddock into which  
riders could turn their horses ~~when~~  
if they arrived at night time or were  
leaving Stanley early in the morning

4  
In regard to coming on cows  
I would suggest that these cows



When within 3 weeks of calving  
could be taken out of areas G, H  
& allowed to graze on area F.  
Working cart horses could also  
be grazed on area F. The grazing  
of these few horses (about 10 at the  
outside) would not do much damage  
to the grass on area F.

Red Carter  
C.S.O.  
25/6/27

Spoke W. McMill.

He is in favour of the construction  
of the fence line A-B but not  
of the line C-D at any rate without  
~~further~~ examination of the ground, which  
he is sure is of poor feeding  
value.

Wm  
14. 7. 27.

Colonel Cyries.

What is the cost  
of construction of the fence



line A-B only on the plan

enclosed in folder vol 2.

2. How does the work stand

under Head XIX item 3, please, urg

(1) 603/26 enclosed ?

*J. M. L.*  
by G. L. L.

14. 7. 27

The Hon. Col. Secy.,

Since writing my minute of 30th March herein a fresh supply of fencing wood has been received from Punta Arenas and this is cheaper than the previous stock. The revised cost, in store, for material required for one mile of fence (six wire) is £45, and for each gate, complete at shop, £3. Carting, per mile £3, erecting £20, making estimated cost of fencing £68 per mile.

2. The plan gives the distance as 1½ miles with three gates.

1½ miles @ £68 equals .....	£102
3 gates @ £3 equals .....	9
	£111, say £120.

3. The unallocated balance under Head XIX., item 3 is .....

.....	£96. 0. 0.
The balance under F.R. No. 2 is .....	17. 6
Total .....	<u>£96.17. 6</u>

*R. B. Aschby*  
Colonial Engineer.  
16th July, 1927.



Col. Pyman

Please arrange to have the fence A-B erected at an early date.

2. If an excess is incurred show the amount of £96 available or the appropriate subhead you can rely on the issue of a S.O. in an amount not exceeding £25.

*J. Pyman*  
9. 4. 27

The Hon. Col. Secy., 17. 7. 27

Noted.

3.

4.

+

2. It is suggested to offer the work for contract and a draft notice inviting tenders is submitted herewith.

3. I am submitting herewith a F.R. in the sum of £96 (the available balance) to enable materials to be purchased. A Special Warrant could, I would suggest, be made out later when the total amount of the deficit is definitely known.

4. I would suggest /



4. I would suggest that intending contractors be referred to the Chief Inspector of Stock for information as to the line of fence and the position of the gateways.

*R. Brassey*

Colonial Engineer.

20th July, 1927.

*J. S.*  
Sketch for approval at  
for 27 volume of F.R.

2 Col. Engineer report will  
arrange details of so small a  
matter himself without reference to the  
Tender Board.

*J. S.*

22. 7. 27.

How C.S

1. Signed. 2. Yes. A.H. 22.7.27.

*W. J. P. Jones*

The Treasurer

Please withdraw F.R  
at pass to Col. Engineer for notes.

*J. S.*  
9. 7. 27

22. 7. 27.



Hon. Col. Sec.

F. R. No 48 withdrawn.

M. Craig Harkness

Secy.

23. 7. 27

Colonial Engineer.

Passed to you.

hr CH

23. 7. 27.

The Hon. Col. Secy.,

Noted.

2. Notice has been altered accordingly, copy herewith.

5

3. Notice, in duplicate, submitted herewith for publication.

W. B. S. S.

Colonial Engineer.

23rd July, 1927.

Chief Inspector of Works.

Please see at once

to co-operate with the Col. Engineer

as regards the details of this matter.

J. W. S.

Col. Secy.

2. 8. 27.



The Hon  
Col Sec.

I shall see the Col Eng.  
& assist him accordingly

The Captain

C. S. S.

5/8/27

Chief Inspector of Stock.

Are you yet in a

position, please, to report as regards

the proposed holding paddock ? /  
from D. McGill

understand that he has objections to

the area originally suggested by you for

his pasture, marked "E" on the plan and 2,

s.f. convenience to the owners of cattle

in Stanley at some future value of

the present draft.

J. W. S. S.

C. S.

5. 8. 27.



the ~~the~~  
col Sec.

The area that I have marked on the chart. ~~shown~~ in red ink Encl (2) has with the exception of the line J.K. already been partly fenced in by the P.W. Dept.

2 If the line J.K. can be fenced in, the area marked in red ink will make a suitable holding paddock for the eastern end of the town.

3 I shall go over the ground to the west of Stanley with Mr. McGill as soon as possible + endeavour to locate a suitable piece of ground for a holding paddock at the end also.

4 Mr. McGill was under the impression that the holding paddock was for animals to be held in for a number of days at a time. The holding paddock was intended for the convenience of people who may wish to make an early start for camp in the morning + to save them the inconvenience of wasting the best part of a day getting their horses in from the common where the horses could be held in the small paddock over night.

5 On several occasions it has come to my notice



people going out - to camp in the  
early morning have turned their  
horses on to the road in Stanley  
so that they ~~would~~ horses could be  
readily caught - in the morning +  
thru insure their owners an  
early start.

The Courier  
P.O.S.  
13/8/27

Chief Inspector of Prod.

I have seen W. McMillan in  
my connection. He was express personally  
at 1 above.

2. What is the length of  
estimated cost of the fence line J-K?

3. Please submit your recommendations  
as to the Switzer whether holding particular  
with Switzer statement of length of estimated  
cost at an early date.

J. McMillan

16. 8. 27



The Hon  
Col Sec

The length of the  
fence line T. K. is approximately  
40 yards & the estimated cost  
of fence completed would not  
be more than £9.

Vide Repts  
12/13

I have again gone  
over the land on the western  
end of the town & have  
submitted my recommendations  
on a separate paper.

T. W. Carter  
C.S.O.  
29/8/27

6-11. Minute from Col. Engineer dated 17 August 1927.

12-13 Minute from Chief Inspector of Stock  
29<sup>th</sup> Aug 1927

Col. Engineer

For any observation that  
you may see to make in the  
matter at for a estimate of



The cost of erecting the fence line J-K  
at the facing necessary to enclose the  
holding paddock proposed on sheet 13 of the  
Map of the Town.

Copy of Agreement dated 31/8/27 *J. M. S. S. S.*  
31. 8. 27. *114*

The Hon. Col. Secy.,

Should a fence be placed on the line J-K the cart track from the East banks would pass through the paddock and there would be three gates giving access to the enclosure. Secondly the old common fence would need extensive repairs as it is in poor condition. Thirdly the grip would be enclosed in the paddock and would soon be trodden in. For these three reasons I am unable to advise that this section of land be enclosed.

It would appear that the paddock is to provide accommodation for camp horses for one night to enable them to be readily caught in the morning and is not required for grazing the horses while they are in the town. Should 2 acres be thought to be sufficient the South section of the Government paddock to the East of the Cemetery might be fenced off. This would require a stretch of new fence about 160 yards long and a few new posts in the old common fence on the South and East sides. Two small gates would be required, one in the West fence on the road leading to the peat banks and one in the fence dividing the Government section from the new paddock. The estimated cost of this scheme is £13.

2. With regard to A. There is nothing in my opinion to prevent this from being done. The estimated cost of the work is £23.

*J. M. S. S. S.*  
Col. Engineer.  
10/10/27



Chief Inspector of Works,

For your consideration

Please

J. Carter  
2/4

11. 10. 27

The Hon  
Cust Secy.

as pointed out by Col. Eng.  
the small gap or gutter running through  
the section might be trodden in.  
I when I submitted my  
plan of suggested paddock Encl. B.  
I did not consider this gutter to  
be of much importance.

I have since gone over  
the ground suggested to the East  
of the Cemetery & I am of the  
opinion that a paddock could  
be made there as recommended  
by Col. Eng.

J. Carter  
C.S.O.  
14/10/27

Col. Eng.

Please see : can be

work if approved to undertake



This year at the money

required - £36 is all - available?

*J. J. J.*

14. 10. 27

The Hon. Col. Secy.,

Noted.

2. The work could be done this year.

3. The provision made in the estimates, viz.,

Head XVIII., P.W.R., item 9.....£50.

Head XIX., P.W.E., item 3.....£2 00.

Total.. £250

has been spent.

The following further amount is estimated to be required this year to cover work completed and works required.

Additional amount required in connexion with the erection of a divisional fence on the Common. (Vide my minute of 14th October in M.P. 440/27) ..... £34. ✓

Renewal of Stockyard fence (M.P. 440/27) ..... £28.

Erection of fencing to provide holding paddocks in Stanley (M.P. 709/24) ..... £36. ✓

£98.

Unforeseen..... 2.

£100.

4. I would suggest that the renewal of the stockyard fence and the fencing of the holding paddocks be undertaken this year, and that approval be granted for the issue of a S.W. in the sum of £100 to cover the known and the estimated liabilities.

*W. J. J.*

Colonial Engineer.

29<sup>th</sup> October, 1927.

*W. J. J.  
29/10/27.*



Col. Eng.

Please prepare Special

Warrants as under

Head XVIII Jan 9 £ 28

Head XIX Jan 3 £ 70

*[Signature]*

31. 10. 27

The Hon. Col. Secy.,

Noted.

2. Special Warrants are submitted herewith accordingly.

*[Signature]*

Colonial Engineer.

1st November, 1927.

15-16

Minute from Col Eng. ~~Special Warrant~~ dated 1/11/27.

G. S.

2,

S. O.s. & submitted for signature

if approved,

*[Signature]*

3. 11. 27

Hon. S. S.

Hon. Secy.

3. 27. 11. 27



Mr. Treasurer

Please withdraw S. O. No. 42/27

at par to Col. Py. to note authority  
to proceed with the work account.

Vindley

4. 11. 27

Colonial Engineer.

S. W. 42/27 withdrawn,  
and papers passed to you.

M. Barry Harthorn  
Treasurer

Mr. H. Secy.,

S. XI. 27

Noted and returned

Barry

Col. Engineer

7/11/27

Bf. 30. 11. 27

Bf. 7. 11. 27.

Minutes from C. I. S. of 7/11/27.

17-18.



C. I. for Stud.

Approved subject to the proposed arrangement being generally satisfactory to the animal owners concerned. Please ascertain at what view of Mr. Mill at other intervals.

2. To show the sufficient time for the work to be published at least the date ought to put back to Nov. 19<sup>th</sup> at 20<sup>th</sup>?

J. Miller

8-11-27

The Hon  
Col Sec

I am of the opinion that the new arrangement will be quite satisfactory although it may not be favourably received by a few who have animals which are not used for the benefit of the public i.e. riding horses.

I have spoken to the Chief



Constable who is in a better position than I am  
ascertain the opinion of the various  
cattle owners. His opinion is that the  
new conditions will be favorably  
received by the owners of ~~the~~ milking  
cows & draught horses but the owners  
of horses used for pleasure purposes &  
also the owners of cattle (dry) may  
question the alterations.

3. In her marking out the new  
fence line I did so in company with  
Mr W. Galt & Mr Hutchinson both owners  
of animals running on the common &  
also men who have had a good many  
years experience with past conditions  
in regard to the common both Mr Galt  
& Mr Hutchinson are of the opinion that  
the only persons likely to object are  
the owners of private horses which  
are used for pleasure purposes.

I may add that these horses  
are only grazed on the common until  
the grass is eaten out each year &  
they are then removed to Lussac Island  
or other land outside the common.  
This of course does not help the  
animals which are grazed on the  
common for use for the benefit  
of the public.

4. In paragraph 2 of your  
minutes of 8/11/27 I think the  
alteration in the dates as proposed  
by you is advisable.

R. Carter  
C. L. S.

9/11/27



J. L.

Schilted for approval to

proceed as proposed.

J. L.

10. 11. 29

Hon C.S.

I am not sure I like this idea. There is nothing so dangerous as tampering with ancient rights. Have people always grazed horses there from time immemorial? There is so little amusement here that I like encouraging people to keep horses. ASK C.S.1. to draw me a small plan (rough, not to scale) so that I can see the position at a glance.

19.27

A.H.

Chief (republic of that)

Referred to you please

accord.

J. L.

18. 11. 29

The Hon

Col Sec

Red 19.

2 Aug to submit herewith a rough plan of the Common as it now stands.

I understand that the Common



has always been used by the public for grazing these animals and a great deal of damage has been done to it by dry cattle such as sters & yearlings no restrictions have been ever made in regard to the grazing of these animals.

3 I have made a good many inquiries & I believe that the majority of animal owners in Stanley are in favour of the proposed scheme I have inspected the 3 areas & have <sup>found</sup> that there is a good deal of feed on the eastern & western ends of the Common the centre area however is pretty well eaten down.

4 Riding horses are generally brought in from camp & turned on to the Common about November each year & are taken off again in March of the following year. These horses number approximately about 50. There are usually about 180 cattle running on the Common of which about 100 are milking cows.



Thos Cartis  
C. S.  
5/12/27

Y.E.

Submitted.

A. J. J.  
10/12/27



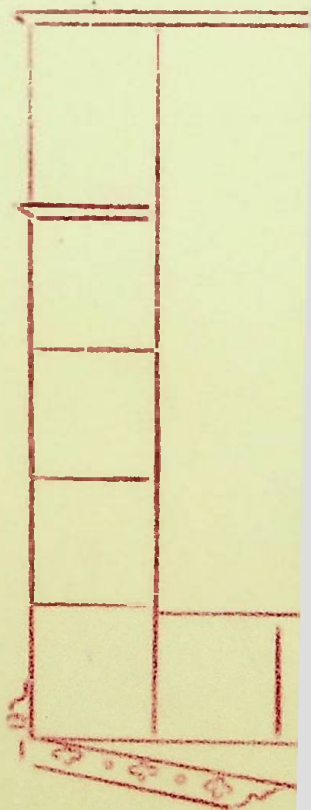
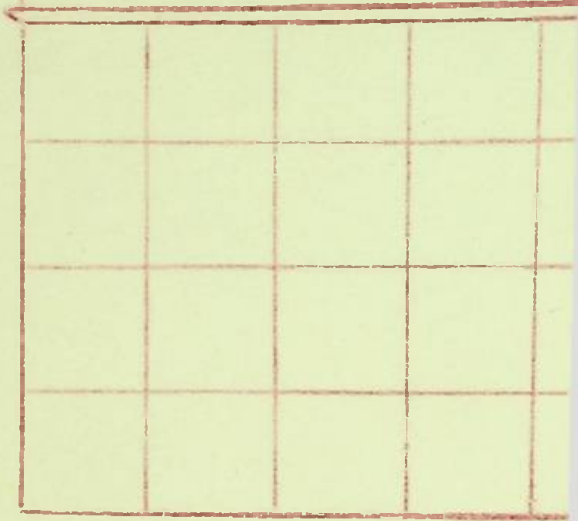
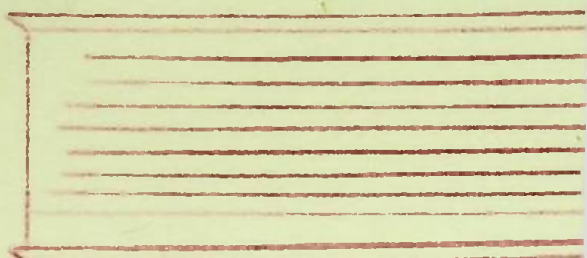



Mr. Flavel.

Pass to Hon members of Council for  
their views.

M.

13/27  
12

Hon. Treasurer  
Hon. H.H.R. Gresham,  
for your remarks please.

A.D.G.  
14/12/27.

Hon. Col. Sec.

The Common appears to be  
overstocked, the condition of the  
animals, particularly the cattle, proves this.  
The proposed separation of grazing areas  
for cattle and horses as shown on  
red 19 may improve matters and  
might be given a trial.

2. Much cows kept on the  
Common are generally in a wretched  
condition due to the inability of  
cattle owners to procure fodder to  
supplement the sparse grazing.

M. Brian Hackett

Treasurer  
20. XII. 27.

The Hon <sup>or</sup>  
H. H.R. Gresham.

Passed to you, please.

Hon Col. Secy.

MCH  
20. XII. 27

I have no actual knowledge of stock but  
consider the Hon Treasurer has rightly  
expressed the state of affairs. H.H.R. Gresham



g. 2.

Submitted: for next meeting

of Ex. Co.?

Just

10. 1. 28

Hon. C. S.

Please.

A. W.

10/28

Hon Treasurer  
Hon G. Bonner }

Circulated

G. P. G.  
Clerk Ex. Co.  
11. 1. 28

Hon <sup>Mr</sup> George Bonner, M.E.C.

Passed to you, please.

Mr. George Bonner

Treas.  
11. 1. 28

John G. B.  
13/1/28

Extract from the minutes of the meeting of the Executive Council held on the 14th of January, 1928.

It was agreed that a notice should be published inviting comments on the proposals put forward and that a letter should be addressed to the Secretary of the Stanley Animal Owners Association requesting an expression of the views of the Association on the subject.

*A. J. Hewitt*  
Clerk of the Executive Council.



709/24

16

C.I. of Stock

Please see and

submit the necessary draft notice.

*[Signature]*

25. 1. 28.

The Hon. Cal Sec.

20

Draft notice submitted  
herewith

<sup>2</sup>  
Very little can be done as regards the changing of grazing areas until about November of this year as there is very little grass on the Common & there will not be very much growth until November. All the stock on the Common have been grazing certain portions very heavily & by altering the grazing areas <sup>this winter</sup> many of the animals would suffer very badly.

The Carter  
C.I.S.  
2/4/28.



Govt notice no 123 of the 17<sup>th</sup> April, 1928.

21.

Chm Treas MCH  
23.4.28

Chm Secy W.M.F.  
24.4.28

Chf Ltrk of 2nd Chm 30/4/28

10 Sec.

July

21. 4. 28

Ltr from Manager, E.L. Williams, of 24.4.28. 22.

Ltr from Mr W.J. Hutchinson. of 25.4.28. 23-24.

Ltr from Mr J. Campbell of 10.5.28 25

4. 4. 7. 28

4. 4. 8. 28.

— 4

Ltr from Mrs. Smith. of 24.5.28 26

" Mrs. H. Waghorn. of 24.5.28 27

" Mr J. Berntsen. of June. 1928 28

" Mr. H. Dettleff of 24 June 1928 29-30

" Mrs. A. Hellman of 26 June 1928. 31-32

" Mrs. K. Lellan of 26 June 1928. 33-34

" Mr. D. Biggs of 28 June 1928. 35

" Mr. H. Clifton of 28 June 1928 36

" Mr. R. Rieve of Mr. H. Jennings of 29 June 1928. 37

" Mr. Thos. Dettleff of 30 June 1928. 38-39

Ltr from Messrs. W. L. W. S. of Aldridge & A. Petersen just 40-41  
of 29.6.28



Ch. Insp. of Stock.

These replies, nos 41-22,  
to the notice, nos 21, are generally  
extremely and helpful.

To C. I. of S. for his  
considered opinion, please.

J. B.

4.7.28.

Ch. Insp. of Stock.

To you accordingly

J. B.  
to C.S. 5.7.28.

The Hon  
Col Sec

The general opinion of the  
stock owners who have submitted their  
views in regard to the scheme proposed  
appears to be

a Cattle shipped from their usual feeding  
ground will hang the fences.

b Dry animals will starve

c Cows actually in milk are in the minority  
will monopolize the best feeding ground.



- a Riding horses would suffer.  
b Draught horses do not require grazing.

As regards

- a Stock when moved from their usual feeding ground will always move up & down the fence nearest their old feeding ground & attempt to get back but this only happens for a short time after being moved.  
On all stations in the Falklands stock are moved from one paddock to another & will leave the fences for a short time but when they get hungry they soon adapt themselves to their new feeding ground.  
As regards the stock on the Common if the proposed scheme is carried out the stock should not be moved in any case in the first place until November as the grass has then started to improve.

b Unprofitable dry cattle are too much on the majority of the Common & I see no reason why so many should be run. The idea should be to run as many milking cows as possible. This cannot be done under existing conditions. It is my opinion that dry cattle should not be allowed to endanger the milk supply of the town. Draught cows that 75% of the cattle run on the Common are dry.

c At any time in each year ~~the majority of the cows~~ actually in milk are greatly in the minority for the simple reason that there is a very big shortage of food available for them on the Common & they are therefore unable to keep up a supply of milk for more than a short period.

d Riding horses usually come into Stanley about November & are sent out to the



camp again about March the following year. It is my opinion that riding horses during the time that they are in Stanley should not be allowed to graze upon land which is being used by milking cows when the horses are sent out of Stanley. There is little enough grass on the Common & the grass does not get a chance to grow again until the time arrives for the horses to come back to Stanley.

For about 7 or 8 months of the year nearly all the riding horses are put on ussua islands & I understand that farmers rarely make a charge for the grazing & therefore the horse owners have a great advantage over the other owners of stock in Stanley.

There is very little grass on the Common & at the present time owners of draught horses would lose by turning their horses out. But I knew that if the grass improved on the Common owners of draught horses would take advantage of the opportunity to fatten their horses periodically instead of keeping them stabled all the time.

The main object of the scheme was to improve the milk



supply & to reduce the number of  
weilers cattle which are usually  
being run on the common & of doing  
away with the cruel practice of  
turning these weilers animal out  
on to the common in the winter  
time to starve. I must say that  
I have never in my life seen  
animals in such a bad condition  
as those running on the common  
during the winter each year.

W. Carter  
C. S. S.

9/7/28

Off the table.

to the charge of the General

at of the Treasurer at the H. K. K. Club,

Member of Council, I do not feel justified

in giving any order - possibly of a revolutionary

description - ~~in this matter~~ Please let W.

Carter see at the 6th 26. 10. 28.

2. to the members of the Faithful

should study these papers at the

question in general.



709/24.

16

3 Please see accompanying  
form where you find a copy shall  
be published in the "Penguin".

Jud

16.7.28.

Govt. notice no. 1175 of 23rd July, 1928.

Chf. Inspector of Stock

To notice

AS. to C.S. 23.7.28

The Hon  
Cul Sec

Thank you - Noted

R. W. Carter  
C.S. S

43 Report of Inspector of Stock 16/11/28.

26/7/28

Off. Sec.

Can Mr. Fairbairn say

please at what he answers.

Copy sent  
to "Penguin" 43  
AS. 23.7.28.



The reasonable carrying capacity

of the Commerce at the present

time?

2. With regard to his

suggestion at "A" on p. 43 The

wisdom of that I do not

personally doubt except from the

point of view of convenience to

the riding public as I have

sent earlier in this A.P. I

regret that I do not see my

way clear at any rate this

year to allow the existing practice

(with also p. 42).

3. The whole position is,

however, serious at present



scandalous at so far as I  
 am personally concerned I do  
 not think for some to let  
 it rest as it is. There is  
 nevertheless good cause here for  
 "justice sake" as this quality  
 the former ~~stage~~ indicated verbally  
 to the Hon. Members of Ex. Co.  
 when this matter came up for  
 discussion.

J.P.S.

20. 11. 28.

Chief Inspector  
 of Stock and Agriculture.

To see and for necessary  
 action on para 1. of His Excellency's  
 minute of the 2<sup>o</sup> of Nov. 1928.

a D.P.  
 Jones



HON. COLONIAL SECRETARY.

I consider the present carrying capacity of the Common 100 Dairy Cows, half the present number of yearlings and the number of horses kept down to fifty. If the stocking was kept down to this number for two years, I am convinced it would give the grass time to come away and in the natural cycle the self sown seed would to a certain extent re-establish the depleted grazing. At present as soon as any growth appears, being <sup>W</sup>seet, it is immediately eaten.

I have seen some of the people who are at present milking cows for town supply, and find that although in some cases as many as 10, and sometimes more than this number of grazing permits are held by one person, they are only milking 3 or 4 cows. If the number of cows was limited, and three or four good, three year old bulls turned out with them I think it would be better. At present half the cows on the Common are not put in calf each year because there are too many of them for the number of useful bulls.

I think it would also help if only yearly permits were granted. At present it is possible for anybody to take a permit for one or two months, and most of these short monthly grazings are done during the summer months so that by the end of the summer the Common is bare.

*W. Faithful.*  
*23/11/28.*

*Y.F. Submitted.*

*A.D.F.*  
*23/11/28*

*Off to Sect.*

*how to Chief*

*Contable, please, for any*

*remarks that he may have  
to make.*



2. I presume that he

has duly collected all the

fees for the curials

reported or not 43. To

what sum do they amount?

3. I am still handicapped

in my desire to approve

all or any of the

recommendations made by the

provisions of the Ordinance,

No 5 of 1904, at the

request of the

provision.

Jad  
23.11.28.

Order page 362



Chief Constable.

For any remarks you  
have to make and will you  
please see para. 2 of H.E.'s  
minute of 23<sup>rd</sup> Nov. 1928. in this  
m.P.

A. J. J.  
J. J. J.  
24/1/28

Hon Col Sect

Sir,

44-46 I attached list showing the number  
of animals licensed on the Common from  
Jan 1928 to present date, all fees have been  
collected and paid into Treasury  
Total amount £151 5 6.

I would suggest that all animals  
licensed during the Easter holidays should  
graze at the West end of the Common.

Annual Grazing Licences are issued between  
the 1<sup>st</sup> and 15<sup>th</sup> of January each year.

I am of the opinion that if a notice was  
posted from the Stock Dept advising that  
all Cows over a certain age say 6 or 7 years  
old should be slaughtered, as I am of the  
opinion that the milking produce of any Cow  
over the above age is decreasing. This would  
I am sure decrease the stock on the Common  
at least 15%.

I further suggest that all the Bulls on the  
Common be slaughtered and that the Gov  
procure two Bulls for use on the Common.

I am Sir

Your Obedient Servant  
A. J. J.

Chief Constable

5/ - 12/ 28



Y/E Submitted  
C. D. J.  
J. W. S.  
10/12/24

Off'ce Sect.

to the chance

from the Library of H. E. The

Governor and also of the

N. C. Crisp - Halkett & an

proposal to fine any order

in this matter altering past

practice, or interfering, directly,

or 'common' rights.

2. Please b.f. 10. 1. 29

for further consideration.



3. I shall be glad if

Inspector of Stock at Agriculture

at Chief Constable will do that

they can personally to discourage

people from keeping useless animals

at to advise them to slaughter

rather than to allow to die

of starvation.

4. Inspector of Stock at Agriculture,

at Chief Constable to see, please.

10.12.24

JW



Inspector of Stock  
and Agriculture,  
Chief Censor,

to see.

C. J. J.  
11/12/28.

Hon. Colonial Secretary

Seen, thank you

Faithful.  
24/12/28

Chief Censor.

to see.

C. J. J.  
29/12/28

G. W. Bremer M.C. J.P.

After reading Mr. Sacthupri's  
Report on the Cattle which were  
allowed to graze on the Communal,  
I consider it is a disgrace to the  
Colony to allow Cattle to die of  
Starvation and suggest that im-  
mediate measures be taken to stop  
this Scandal - Reduce the number

x dated 16 Nov. '28



of cattle on the Common and have  
all useless & rubbish killed. If these  
measures are taken, and I am  
assured that the Common will not be  
overstocked in the future, I will willingly  
supply milk cows (free of charge) to those  
who cannot afford to buy other stock,  
in place of those you condemn.

Geo. Pomeroy

8. 1. 29.

Y. P. Schell. This matter still remains  
most difficult of solution. As Y. P.  
has said it involves the right of  
interference with "common right" as in

read section 10 of the Trespass Act.

No. 5 of 1904 so long as the prescribed

fee is paid no power exists to

strip any animal from being present on

the common. Furthermore compulsory distribution

involves compensation at the side legal



authority for such compulsory distribution  
 at cooperation of Part 1 an area  
 is not provided in the Part of  
 State Dy. Laws, section 31, in the case  
 of tubercular cows.

2. A similar objection arises  
 against the proposal to sub-divide the  
 common into areas of Part 1  
 but shall be reserved for milking cows.

3. Y.E. will see from sub

41-22 that the consensus of opinion  
 in the State is almost unanimously  
 opposed to the proposal made in  
 sub 21.

4. In the circumstances I  
 am compelled reluctantly to recommend  
 that no action be taken in



No further follow to vol 42 at as

directed by minute of 10. 12. 28.

I will call for ~~minutes~~ <sup>minutes</sup>

of the Agriculture at Chief

Please to  
no.

Comptroller for a report as to the

immediate position.

Just

17. 1. 28.

For C.S.

It is a difficult question. Something  
shall be done to prevent animals  
suffering and legislation will probably  
have to be introduced for this purpose.  
i.e. if in the opinion of the Stock  
Inspection animals are dying by slow  
degrees of starvation they shall be  
slaughtered & put out of their misery.

Bring up for discussion at next  
Council meeting.

CH.

1729



Chief Constable.

For report, please.

J. M. Min  
—  
—

18. 1. 28.

How Col Sect

Sir,

The majority of deaths of animals on the Common during the winter months for many a year is in my opinion mostly due to the neglect of their owners, in this way.

Some owners who have cows up in the summer months, do not feed them enough and too much milk being taken from the cow, consequently the calf is ~~starved~~ impoverished, when bad weather sets in, and feeding on the Common becomes poor the cow & calf is let go for the winter in very poor condition the cow still nursing her calf

2) ~~at~~ we had during last winter a death rate of about 20% of the animals feeding on the Common this death rate will ease a great lot for the coming winter.

I would offer three suggestions, which may help to improve the Common.

- 1) That householders in Stanley who desire to keep milch cows for their own use be allowed to graze two cows on the Common at the usual fee.
- 2) That one or more persons have the sole right to keep a certain amount of milch cows on the Common for the purpose of supplying the householders of Stanley who require milk.
- 3) That a section of Crown reserve in the Surbarban lands be set apart for yearlings and two year old animals



and no other be put on the Common  
or the Crown reserve.

W. J. Sullivan  
Chief Constable

31-1-29

Extract from minutes of meeting of Executive Council  
held on the 2nd of February, 1929.

The Council concurred that an Ordinance should be drafted for the prevention of cruelty to animals to come up for consideration at an early date, and that in the meantime enquiries should be made with a view to the possibility of making available additional areas of Crown Land for the purpose of grazing animals thereon.

A. J. Hewitt

Clerk of the Executive Council.

Draft Bill is re "Cruelty to Animals" is

under preparation in accordance with the V.V.

No additional areas are immediately

available for the purpose contemplated

but on the lapse of any of the

existing leases for suburban Crown Land,

i.e. to Messrs. Brown, Becher, at McGill,

the matter might come up for



consideration.

jud

13.3.29.

y.p.

Those notes submitted for

y.p. is sanction of expenditure of

approval.

2. The Members of Sec. Co.; Dr

J. H. P. P. P. C. U. S., Inspector of Stock and

Agiculture, at Chief Controller to see?

jud

13.3.29.

Hon C.S.

approval.

Please.

Atb.

Hon. Treas.

Hon. Gen. Secy

Dr J. H. P. P. P. C. U. S.,

Inspector of Stock & Agriculture.

Chief Controller.

Please see

jud

14.3.29.

(13/29)  
0



Hon Col Surgeon.  
Noted & passed to you

H. Chen  
W. Measur  
14/3/29

Hon Col. Sec.

Noted & passed to you.  
J.M. Col. Surgeon. 15-3-29.

Hon Col Secy  
Seen

J.H.D.  
15/3/29

Hon. Col. Secretary

Seen, thank you. I intend to go round the common during this week and will report further on the general condition of the stock then.

Faithful  
14/4/29.

Hon Col Sec

noticed  
J.P. Sullivan  
Chy boost

17- 4-127

ft, 25/4/29

Hon. Col. Secretary

I have been round the common and notice a decided improvement in the condition of the cattle. The reason being that since December there has been quite a flush of feed and the stock have benefited thereby. At the present time the feed is of course about finished. Provided this coming winter is not too severe, I do not think that the position



will be as bad as last winter, but I shall, ~~if~~  
while I am here, keep a watch on the cattle  
and if I see anything too weak to fossic  
for itself shall order its destruction or it  
will have to be housed and hand fed.

Yours faithfully,  
23/4/29.

Y.S.

I.M.H.

Yours

27. 4. 29.

1/2 C.S.

noted.

M.

(27/27)  
u

~~27~~ 30. VI. 29.

~~27~~ 29. IV. 29

T. O. To see and for your  
report - please.

S.M.

A.C.S.

3. VII. 29



Hon. Mr. Craigie. Halkett.

You have a long experience of matters relating to the Common & grazing. I should therefore like your opinion of Mr. Morton's suggestions before submitting the report to Her Excellency.

G.H. 13  
A.G.C.S.  
30. ix. 29

Hon. Col. Sec.

In my minute of the 20<sup>th</sup> Dec<sup>r</sup> 1927 I expressed the opinion that the Common was over-stocked. From the figures given in (47) it would still appear to be over-stocked and as a result the ground has no chance of recovery.

2. Very few horses are kept on the Common during the winter months but during the summer the numbers are increased considerably and thus no grazing is left for the winter.

3. I do not agree with the suggestion that the number of licenses should be limited. I consider the fees for horses to be high enough, but the fees for cattle might be amended. Fees for milk cows might be as now, viz: 1/6 per month or 10/- per year but "dry" cattle might be increased to 3/- per month or £1 p. a., this would probably have the effect of reducing over-stocking as owners would not keep useless cattle if a higher rate was charged.

3 x. 21 W. Craigie Halkett



Extract from Col Engineer's Minute of 19/10/29

Y. J. Submitted. Ref. Red 48. In the circumstances it would not seem worth while refencing the divisional fence. Ref. Red 47. I suggest an alteration should be made in the fence in the meantime. I have spoken to Mr. Norton on the subject. He is of opinion that strict enforcement of the Milk Supply Protection bye-laws will in time cure the overcrowding on the Common.

Y. J. Submitted. Ref. Red 48. In the circumstances it would not seem worth while refencing the divisional fence. Ref. Red 47. I suggest an alteration should be made in the fence in the meantime. I have spoken to Mr. Norton on the subject. He is of opinion that strict enforcement of the Milk Supply Protection bye-laws will in time cure the overcrowding on the Common.

G.R.B.  
A.G.S.  
2.11.29.

Bring up at next council meeting. With reference to Enclos 48. It is obviously no good leaving the fence there. Could not the posts & wire be used for other purposes? Do the gate could not careful inquiries be made? It has probably been stolen & credit clearance & shall be easy to recognise. (4-29) M.H.

P.S.  
Perhaps it would be cheaper to see the fence by auction?

M.H.



Hon. R. Roberts.

For info. What are your suggestions regarding disposal of material?

E.K. 18  
Aq. C.S.  
5. XI. 29.

Hon Col Sec.

It is obvious from the correspondence 22 to 41 that the Public are not in favour of this fence. Approximately  $3\frac{1}{4}$  mile of the fence has been cut and thrown down. The gate missing was last seen laying off in the kelp, having been thrown into the sea. It will cost £16 to dismantle the fence and transport to the Dockyard, the recoverable value to the Govt is £25 so we should gain £9 by removing the fence and would require a S.W. to cover the £16 it seems hardly worth it.

I would suggest we advertise the fence for sale and removal by tender we need not accept if it does not <sup>pass</sup> ~~pass~~  $\frac{7}{11}$  C. Roberts 6.11.29.



C.S.O. No. 709/24

Inside Minute Paper.

Sheet No. 26

Colonial Engineer.  
With you please draft notice  
for publication in the Penguin  
G.R. by  
A.G.S.  
12. XI. 29

Hon. Colonial Secretary.

Submitted. Draft notice for publication  
in "Penguin":-

"Tenders are invited for the purchase and  
"removal of approximately 1½ miles of post and  
"wire fencing (approximately 138 posts, 16 yards  
"apart with the necessary battens and wire)  
"situated on the Common and running from  
"Mr. Dettleff's paddock in a Southerly direction  
"to Eliza Cove.

"The whole is to be dismantled and removed,  
"post holes filled in, and the site left tidy.

"Tenders should be addressed in sealed  
"envelopes to the Colonial Engineer, and marked  
"Tender for fence", and should be delivered  
"on or before Monday the 2nd. December, 1929."

C. Roberts.

Colonial Engineer.  
18th Novr. 1929.

Submitted for approval.

G.R. by  
A.G.S.  
19. XI. 29.

OK. 19. 29  
11

Notice published in issue of  
"Penguin" of 21/11/29



Col Engineer,

to note

~~W. J. J.~~  
C. J. J.  
for  
2/11/29

Hon Col Sec

noted

C. Roberts  
C. E. 23-11-29.

R. H.  
Melapra

minute from Col Engineer. 9/11/29 49-50.

28.

Submitted for approval.

G. H. 14  
Aug 15.  
8. 11. 29.

G. H.  
9/29.  
12

Col Engineer,

to note.

C. J. J.  
for  
9/12/29.

Hon Col Secretary.

Noted. Mr Mc Kay informed.

C. Roberts.  
Col Engineer  
10/2/29



C.S.O. No. 709/24

Inside Minute Paper.

Sheet No. 27

Hon. Treasurer, <sup>W. E. H.</sup>  
<sub>12. 12. 29</sub>  
Hon. P. M. D. <sup>J. M.</sup>  
<sub>14. 12. 29</sub>  
circulated for consideration  
at next meeting of Executive  
Council.  
C. J. Stewart  
Clerk, Executive Council,  
12 Dec 1929.

Extract from Minutes of Meeting of Executive  
Council held on 9th January, 1930.

The Council considered the question of repairing the divisional fence on the Common which had been erected in 1927 for the purpose of the improvement of the pasture.

It was agreed that as the fence had been wilfully cut in several places it was inadvisable it should be repaired.

The Council further considered the question of the amendment of the existing scale of grazing fees with a view to relieving the overstocking of the Common by poor and diseased animals.

It was agreed that such action was inadvisable and that its object would be served by the enforcement of the Cruelty to Animals Ordinance and the Stanley Milk Supply Protection Bye-laws. In this connection His Excellency informed the Council that the Honourable G. Bonner had kindly undertaken to replace any animal destroyed under Section 13 of the above-mentioned bye-laws by one of his herd of Angus bred cattle at a nominal cost of £3.

The Council desired that their warm appreciation of Mr. Bonner's generous offer should be placed on record.

*C. J. Stewart*

Clerk of the Executive Council.

by 30/4/30.  
C. J. S. 23/1/30.



Minute from Col Eng 17/3/30

51-2

G. S.

Submitted for approval.

Jul

18.3.30

Hon. C. S.

Approved.

M.H.

19.30

20

Hon Colonel Engineer.

For m.t.

G.H.B.  
for C.S.

19.3.30

Hon Col Sec

noted & offer accepted.

C. Roberts

C.E. 20/3/30.

Hon Treasurer.  
Local Auditor.

For m.t.

G.H.B.  
for C.S.

21.3.30

Hon. Col. Sec.

Noted. Will the Col. Eng<sup>r</sup> to see that the sum of £6 is paid to the Treasury.

Marianne Harkett

Treas

26.5.30



C.S.O. No. 709/24

Sheet No 28

Inside Minute Paper.

Hon Col Sec

Notia a Pittman

Local Audit

31 March 1930

Hon Colonial Engineer.

Please report when sum  
of £6 has been paid.

R. 13  
for C.S.  
31.11.30

Hon Col Sec.

The money will be paid  
to the Treasury the day it is  
received at this office, in  
common with all other monies  
received.

Is this £6 to be paid in  
under some special head, or is  
there a query as to who shall  
receive it. I may be a little  
dull, but I fail to see Hon Col  
Treas & Asst Col Secs meaning,  
about reporting when the £6 has  
been received.

C. Roberts over

3/4/30



Hon Col Sec.

The \$6 has been paid into the  
Treasury today.

C. Roberts.

4/4/30.

Hon Colonel Engineer,

I now understood the  
the Treasurer's minute was a  
query as to whether payment would  
be collected by you or paid direct  
to the Treasury.

2. I regret I misunderstood  
the intention of her minute.

S.P. 14  
for C.S.  
4. 11. 30

Hon Col Sec

Noted. Thank you

C. Roberts.

4/4/30.

PA. 5. 11. 30

RB.

R.A.



927

The Quartermaster

The Hon Colonial Secretary  
Stanley

Stanley  
4 November 1924

Sir

As suggested by you I rode over the Common yesterday in company with the City Constable in order to determine whether I could submit any suggestions that might be of assistance in connection with the Stanley milk supply.

At present the Area is divided into two paddocks by a fence running from behind Government House to the Eastern corner of Mullet Creek farm but this does not prevent the dairy stock from crowding onto grazing out the Camp immediately behind Stanley, which should, in my opinion, be completely reserved for cows that are actually being milked & those within say fourteen days from calving.

I am of opinion that substantial benefit would be derived by subdividing the Area into four paddocks in a manner that would enable sufficient of the Stanley frontage to be reserved for the class of Cattle referred to in the preceding paragraph.

This would also enable the best use to be made of the outlying portions of the Area for grazing dairy stock.



I suggest that no dry cattle other than those close to Calving should be allowed on the front subdivisions & that persons desiring to graze horses on them should pay double the ordinary fee. The extra feed that should be available for horses under the altered conditions would justify this.

I suggest that the public should not be permitted to graze steers on any portion of the reserve & that they should be strongly discouraged from grazing more or less useless animals of any kind.

In event of the grass getting ahead of requirements on the front subdivision at any time dry cattle could be turned in to clear it up & it should be good policy therefore to make these subdivisions sufficiently large to provide for all possible requirements.

I recommend that a certain percentage of the revenue, say ~~twenty~~ <sup>twenty five</sup> pounds, should be expended annually on improving the pastures of the front subdivisions by sowing & sowing with suitable grasses, & that all areas so treated should be indicated on a plan of the block for future reference.

It would be very beneficial to have an area of good pasture where



milking cows could be turned out  
to graze on Condition during the  
period of resting & for this  
purpose I suggest that a  
sufficient area of the best  
pasture on the Peninsula  
which is at present occupied  
by Mr. J. M. Gill should be set  
aside for this purpose.

Providing the pasture on this area  
was not overstocked the Government  
would be justified in charging  
nine pence (?) per head per week  
for cattle grazing on it  
notwithstanding that they might  
be licensed for grazing on the  
Common.

I would very much like to have gone  
into this matter more carefully  
so that I might prepare a plan  
showing the proposed subdivision  
& submit more definite  
recommendations but unfortunately  
the time at my disposal will not  
permit this.

I have however discussed the  
matter at length with the Chief  
Constable who, I understand, is in  
charge of the reserve.

I am  
Yours  
Obedient servant  
H. M. M. M.,



# FALKLAND ISLANDS.

## REQUISITION TO INCUR EXPENDITURE.

ORIGINAL.

DUPLICATE

HEAD OF ESTIMATE ~~GEN. PUBLIC WORKS EXTRAORDINARY.~~  
SUB-HEAD 3, Fencing Crown Lands.

Treasurer's }  
No. 48 }

State in detail, service or article, &c., on which the amount is to be expended.

Estimated Cost.

£ s. d.

Erection of six-wire fence to extend from South-east corner of Town fence to Eliza Cove. Approximate length 1 1/2 miles. (M.P. 709/24)

Materials.

	s. s. d.
150 round posts	28. 2. 6
15 large posts	4. 0. 0
1150 battens	14. 19. 0
18 coils plain wire, No. 10.	25. 0. 0
1 cwt fencing staples, assorted	2. 8. 6
3 gates, complete with ironwork	9. 0. 0
12 struts for gateposts	2. 0. 0
	285. 10. 0

Labour.

Carting materials	4. 10. 0
Erecting fence (part)	6. 0. 0
	10. 10. 0

296

N.B.—When this space is insufficient, sheets should be attached, but the sum total shown on this.

Vote on Estimates.	}	£200 : :	Expenditure authorised to date.	}	£104 : :	Balance available.	}	£96 : :
--------------------	---	----------	---------------------------------	---	----------	--------------------	---	---------

Comments of Treasurer in submitting to Governor.

Signature of Head of Department. } W. Brassey  
Colonial Engineer.

Balance available as stated

M. Braique Halliday  
Treasurer, 21/7/27.

Date 21st July

Decision of Governor.

Amel Holden

Date 22. 7. 27 19



(5)

GOVERNMENT NOTICE.

---

FENCING.

---

Tenders are invited for the erection of a six wire fence to extend from the South-East corner of the Town Fence to Eliza Cove. Approximate length of new fence one and a half miles.

Approximate number of posts (including gate posts) 165

Average distance between posts 16 yards

Average distance between battens 2 yards

Three gates (supplied by the Government) are to be hung.

Posts are to be sunk not less than three feet in the ground.

Posts are to be barked.

The fence is to be anchored where required.

The battens will be stapled to the wires.

In places where it is not possible to fix a post owing to solid rock or reef, a crate is to be erected.

Heavy straining posts are to be placed at intervals of about 250 yards in the fence.

The fence must be made cattle proof at the shore end, either by means of crates or by a stone wall, as considered best.

All materials and necessary tools will be supplied by the Government.

Tenders will be considered for:-

(A) Erection only;

(B) Erection and carting of all materials.

The work must be done to the satisfaction of the Colonial Engineer.

Full particulars, including line of fence, position of gateways, etc., can be obtained by intending contractors on application, during office hours, to the Colonial Engineer.

The Government does not bind itself to accept the lowest or any tender.

Tenders should be addressed to the Colonial Engineer, should be marked "FENCING" on the outside of the envelope, and should be deposited at the Colonial Engineer's office on or before the 30th of July, 1927, at 12 noon.

*W. B. Ashley*  
Colonial Engineer.

23rd July, 1927.



Port Stanley.  
Aug. 9<sup>th</sup> 1929.

Comdant.

Sir.

With reference to the contract for dragging out, and erecting cross fence on Stanley common. I herewith forward tender for the sum of £70. (Seventy pounds) for carting out and erecting same.

I am,

Sir.

Your obedient servant.  
W. J. Hutchinson.

The Colonial Engineer.  
Stanley.



(7)

Stanley.  
July 30<sup>th</sup> 1927.

To The Colonial Engineer,

Sir, I Beg to apply for  
the Contract of fencing from Lya  
Cove to the South East Corner of  
the town.

I will cart the fence out  
and Erect it for the sum of  
£80.

Yours Truly,  
John Miller.



(8)

Port Stanley  
August 12<sup>th</sup> 1927

Colonial Engineer Office

Sir

I beg to offer a tender for the contract of a fence to run from the east common fence to the east of Elyza Cove. I offer to cart the mile & three quarters & erect from for the sum of £ 66. that is carting from the Government Dockyard if the Government puts the material at east common gate or at the gate leading out towards the gaps. I will cart & erect for the sum of £ 62.

I am

Yours Obediently  
E. J. Aldridge



9

August 12th 1927,

The Chairman of the  
Tender Board,

Sir

With reference to your  
notice re Common Fence, I beg to submit the following  
tender for erecting and carting for the sum of £60  
sixty pounds.

<sup>FF</sup> £100 to be deposited at Common Gate.

I am

Sir,

Your obedient servant

C. Hennrichsen



Port Stanley.  
Aug. 11<sup>th</sup> 1924.

Sir.  
With reference to my tender for the barling and erecting of cross fence on Stanley common, for the sum of £70 (Seventy pounds) I am prepared to cart and erect same for the sum of £65 (sixty five) if the Government will send all material at the gate on East end of new common fence.

I am  
Sir  
Your Obedient Servant.  
W. J. Hutchinson.

The Colonial Engineer.  
Stanley.



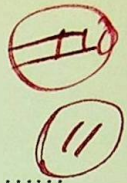

## MEMO.

Departmental Number.

From The Colonial Engineer.....

Date 17th August, 1927.

To The Hon. Col. Secretary..

Erection of divisional fence on the common.

(M.P. 709/24)

Reference  
Numbers.

The Hon. Col. Secy.,

With regard to the erection of the cross fence on the common. This work has been hindered owing to unavoidable delay in marking out the line of the fence and also on account of the high tenders received.

2. Tenders are enclosed herewith. These were considered in consultation with the Chief Inspector of Stock and it was agreed that they were too high.

3. Arrangements have been made for the fence to be erected by the P.W.D. labourers on contract for the sum of £40, the work to include the making and erecting of a gate and the hanging of gates. The materials will be placed on the site by the Government. The cost works out at about £23 per mile.

The work will commence as soon as the weather becomes favourable.

*P. B. Aschley*  
Colonial Engineer.

17th August, 1927.



112

ROUGH CHART SHOWING SUGGESTED HOLDING PADDOCK 'A'

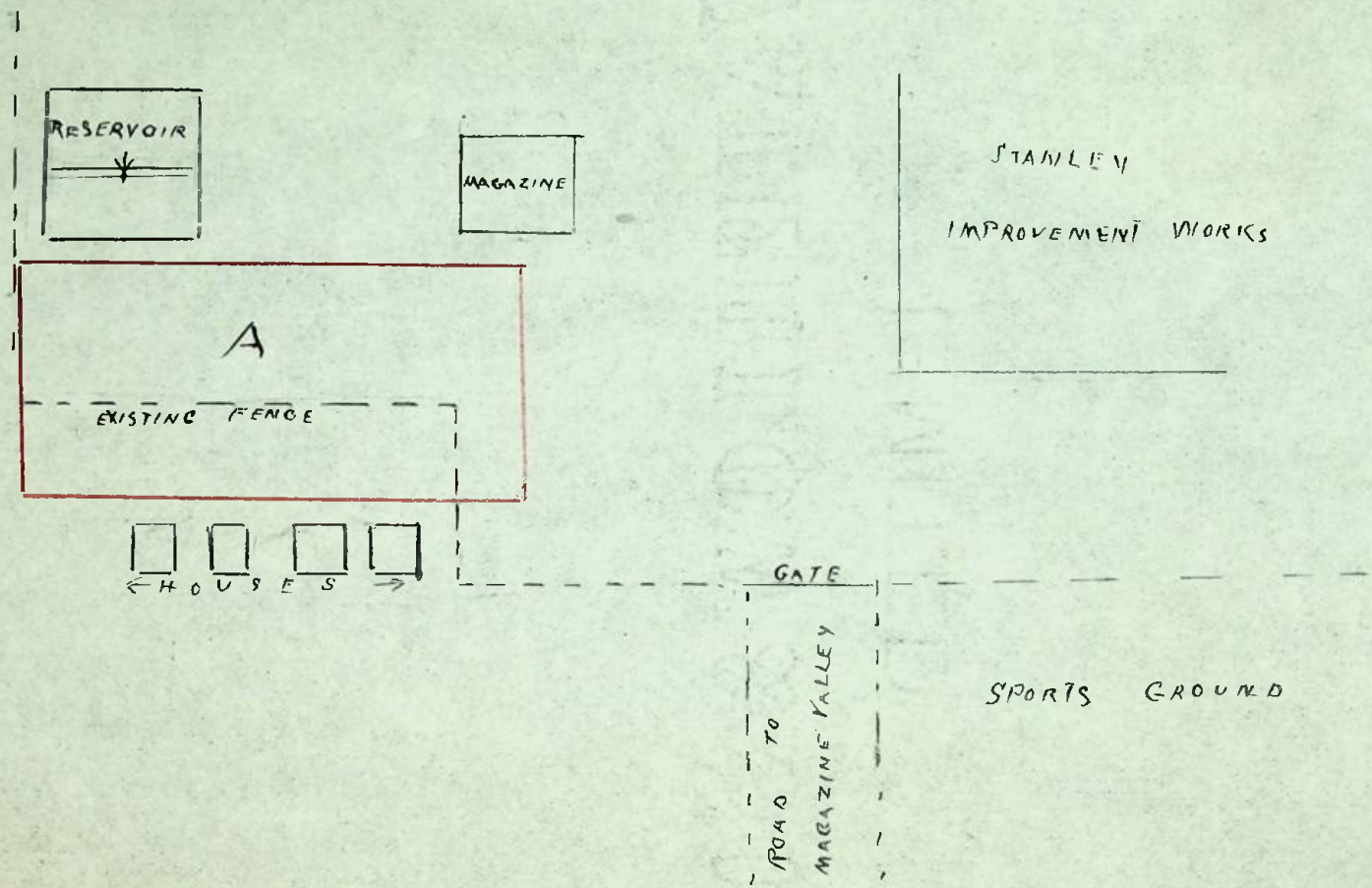



MINUTE PAPER.

Departmental Number.

From *Chief Inspector of Police*

*XV*

Date.....

To *The Honourable The Colonial Secretary*

Reference Numbers.

I beg to submit herewith a rough sketch showing an area (A) which I believe would be suitable for a holding paddock for animals in the west end of the town.

<sup>2</sup> I have gone thoroughly over the ground at this end of the town & I cannot find a more suitable area for a paddock than the one I suggest.

<sup>3</sup> A good deal of the existing fence could be taken down & recreated on the line marked in red ink. & this would enclose an area of about 4 1/2 acres.

*T. W. Easter*  
C.P.S.

29/8/57



14

AGREEMENT FOR THE ERECTION OF A SIX-WIRE FENCE.

(709/24)

I, ERIC BIGGS, (Contractor) agree with the Colonial Engineer to erect a six-wire fence to extend from the south-east gateway in the new town fence to Eliza Cove, as marked out, for the sum of Forty pounds (£40).

GENERAL CONDITIONS.

Average distance between posts 16 yards

Average distance between battens 2 yards

Four gates are to be hung.

Separate hanging posts are to be sunk for gates; each post is to be at least 3 feet away from the straining post and battens are to be placed between the straining post and the gatepost.

Posts are to be sunk not less than three feet in the ground

Posts are to be barked.

The fence is to be anchored where required.

Battens are to be stapled to wires, the staples being staggered.

In places where it is not possible to fix a post owing to solid rock or reef, a grate is to be erected.

Heavy straining posts are to be fixed at intervals of about 250 yards in the fence.

The fence must be completed so as to be cattle proof at the shore end.

All materials and necessary tools will be supplied and delivered at convenient places on the line of the fence by the Government.

The work must be followed without intermission, weather permitting, until it is completed.

The contractor will be required to carry out the work in a thoroughly sound and workmanlike manner, to the satisfaction of the Colonial Engineer, notwithstanding anything which may have been omitted, either from the notice dated 23rd July, 1927, or from this agreement.

Signed this 31<sup>st</sup> day of August, 1927.

E. Biggs  
Contractor.

[Signature]  
Colonial Engineer.

[Signature]  
Witness.







16

Date 1st November, 1927.

To

THE HONOURABLE COLONIAL SECRETARY.

I have the honour to apply for a Special Warrant for £70,000.

on Head XIX. P.W.E.

Sub-head 3, Fencing Crown Lands.

The present state of the Vote is as follows :—

Amount provided in Estimates	£ 200 .	
Special Warrant already issued No.	" " "	
"    "    "    "    No.	" " "	
Actual Expenditure to date	157 . 15 . 8	✓
Outstanding Liabilities incurred	76 . 1 . 11	
Balance remaining on vote	42 . 4 . 4	✓
Estimated Expenditure to 31st December	27 270 . 0 . 0	

Comments of Treasurer.

Issued Special Warrant appd: in c.s 709/24.

M. Brian Halbert

P. B. Ashley, Head of Department, Colonial Engineer.

EXPLANATIONS.

(If general authority has been given for the Expenditure the number of the Minute Paper and the Secretary of State's despatch, if any, should be quoted).

(M.P. 709/2@)

19

To

THE HONOURABLE TREASURER,

Special Warrant No. attached herewith for necessary action.

Colonial Secretary.





# Notice

It is hereby notified for general information that that portion of the Stanley Common enclosed by the fences running from the eastern end of Stanley to Eliza Cove & from Magazine Valley to Mullet Creek shall <sup>be</sup> after the <sup>20<sup>th</sup></sup> ~~20<sup>th</sup>~~ of November <sup>1927</sup> be used only for cows actually milking or within one week of calving or for horses used only for cart or draught work in Stanley.

All applications for permission to use the above mentioned land for grazing purposes must be made to the Chief Constable Stanley, & only animals approved by <sup>the</sup> Chief Constable will be permitted to graze on this land after the above date.

19<sup>th</sup> ~~18<sup>th</sup>~~ <sup>20<sup>th</sup></sup> November, 1927, & such animals ~~which~~ as have not been approved by <sup>the</sup> Chief Constable will be removed to the paddocks to the Eastern or Western end of the Common.





18

FALKLAND ISLANDS.

C.S. No.....

MINUTE PAPER.

Departmental Number.

From *Chief Inspector of Stock*

*XV. Stock*

Date.. *7<sup>th</sup> November 1927*

*The Honorable Colonial Secretary*

*Grazing of Stock on Stanley Common.*

Reference Numbers.

Now that the work of fencing off of the central portion of the Common is completed I beg to suggest that all animals with the exception of cows actually milking, or within one week of calving or working horses be removed.

2 I would further suggest that in the event of the gates in the subdivisional fences being left open after the stock have been sorted out that locks be procured & these gates kept locked.

3 Attached herewith is a draft notice calling the attention of the public to the new conditions

*T. W. Carter  
C.S.*



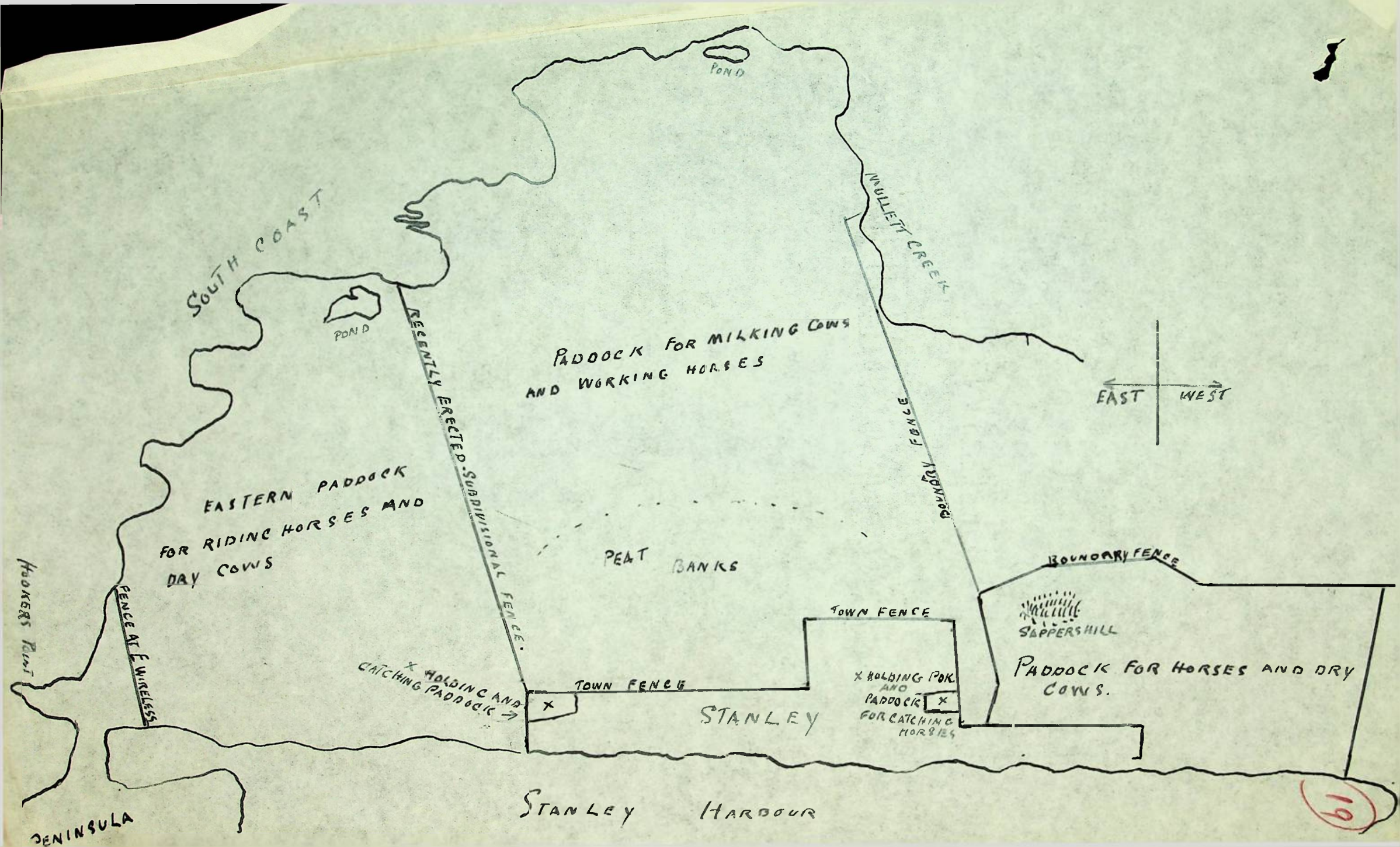

SOUTH COAST

POND

WULLETT CREEK

POND

Paddock for milking cows  
and working horses

EAST WEST

EASTERN Paddock  
for riding horses and  
dry cows

RECENTLY ERECTED SUBDIVISIONAL FENCE.

PEAT BANKS

FENCE BOUNDARY

BOUNDARY FENCE

SAPPERS HILL

Paddock for horses and dry  
cows.

TOWN FENCE

TOWN FENCE

STANLEY

X HOLDING PK.  
AND  
Paddock X  
FOR CATCHING  
HORSES

X HOLDING AND  
CATCHING Paddock →

STANLEY HARBOUR

PENINSULA

19



No. 123.

GOVERNMENT NOTICE.

Colonial Secretary's Office,  
Stanley, Falkland Islands.

17th April, 1928.

The public is hereby notified that the Common has been divided into three sections and that it is proposed that the central section which is enclosed by fences running from the eastern end of the Town of Stanley to Eliza Cove and from Magazine Valley to Mullet Creek should now be used for the grazing of cows actually in milk or within one week of calving and for horses used for cart or draught work. It is proposed that all cattle and horses other than those mentioned above shall be grazed on either the eastern or western sections of the Common.

Any person interested in the grazing conditions of the Stanley Common is hereby invited to submit his or her views in regard to the proposed arrangement in writing to the Colonial Secretary, Stanley, by the 30th day of June, 1928.

By Command,

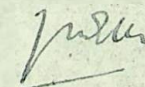

Colonial Secretary.

M.P. 709/24.





709/24



22

ADDRESS ALL CORRESPONDENCE TO THE MANAGER

# ESTATE LOUIS WILLIAMS

GENERAL MERCHANTS

PORT STANLEY  
FALKLAND ISLANDS

RADIO ADDRESS  
"WILLIAMS"  
CODES USED:  
BENTLEYS  
A.B.C. 5TH ED  
A.1.

24th April 1928

Sir,

re Stanley Common.

We notice in today's paper that comments are invited re above.

We would suggest, in view of the regulations which exist governing the use of the Common, that it would be convenient that a mounted policeman ( or similar minor official invested with proper authority) should be employed to see that the rules of Common are enforced, and that all cattle using the Common pay the corresponding license.

We are under the impression that the license fees would more than cover his wages, and in order to make the post sufficiently attractive perhaps the man might be allowed to accept 'tips' for bringing in horses and cattle.

A man permanently employed as a sort of free ranger on the Common would save the general public a lot of time when seeking horses or cattle, as he would soon become acquainted with almost every animal on the Common and know the particular haunts of each.

During the winter months he would also save <sup>many a</sup> milch cows from a cruel death, as cows are frequently bogged and die a lingering death.

We are, Dear Sir,  
Yours faithfully,  
p.p. Estate Louis Williams

The Hon.  
The Colonial Secretary  
Port Stanley,  
Falkland Islands.



C.I.S.

COLONIAL SECRETARY'S OFFICE  
25 APR. 1928

74

Port Stanley.  
April 25. 1928

To.  
The Colonial Secretary.  
Stanley.

Sir

With reference to the Government notice in the "Penguin" of the 24<sup>th</sup> April, 1928. concerning the proposed arrangement of animals on the Stanley Common. I wish to express my views on behalf of my mother (Mrs J Idow) and myself.

In my opinion, I think the animals at present on the Stanley Common, would be better left for the winter months on the ground that they have been feeding on all the summer, and arrange for all animals (excepting cows that are up milking, cows about to calve, and draught horses) to be shifted into the East or West section about the end of October, as any animal shifted from its feeding ground



at this time of the year will hang  
to the fence and feet to get back to its  
own feeding ground.

I am

Sir,  
Your humble servant,  
W. J. Hutchinson.

Pennington





25

Stanley,  
May 10th, 1928.

The Honourable,  
The Colonial Secretary,  
Stanley.

Sir,

In reference to the Government notice of the 24th, April, regarding grazing conditions on the Stanley Common, I beg to state that I am not in agreement with the proposal.

I should like to point out that the cows actually in milk, at any time, are a very small minority of the cattle grazing on the Common, therefore if the central section, which is the best grazing part of the Common, is to be used for those few cows and the cart horses only, the other cattle and riding horses will die of starvation on the two end sections.

I am, Sir,  
yours respectfully.

*W. Campbell*





26

Stanley  
May 24<sup>th</sup> 1928

Sir,

I have seen a government notice dated April 24<sup>th</sup> 1928 asking opinions about shifting the dry cattle on the Common from the centre part, some to the East part and some to the West part. And to keep the milk cows and cart horses in centre part. I am of opinion that it would over crowd the East and the West parts, as the bulk of the animals would be there, and the centre part would only benefit a few carters. My cows feed at the East end of the common and when they are not milking if I put them in the centre part they would only roam along the fence and the feeding I gave them when they came home would be very little good. And when they went dry I would have to put them back on the East end of the common to starve as it would be cropped bare by the dry animals and 40 or 50 riding horses that would be put there in the summer. As riding is the only pleasure we get here in the summer I think it would be better if the animals could roam about they would find better shelter and feeding.

To  
The Honourable Colonial Secretary  
Stanley Hallakland Islands

I have the honour to be  
your <sup>Sir</sup> Obedient Servant  
Thomas Smitte



COLONIAL SECRETARIAT  
20 JAN 1928

27

M<sup>r</sup> A Waghorn  
Stanley

Sir/

In reference to the proposed condition of the grazing the cows on the common I do not agree to my animals being shifted, as by shifting them they will hang the fences and die being on strange ground. My licence to the Government is on an average of eight pounds a year, the mistake is there is far too many riding horses at the present coming over here on the common, as the Farmers cannot put them on the island and the milk cows have to suffer, and when a woman pays eight pounds a year and 12/6 a bag for pollard 2/- for a bail of hay, I am sure she cannot afford to lose them by shifting them off their feeding ground. I am quite willing to shift my animals in the spring when the grass is making providing the riding horses go to and leave the center for the milk cows, as the cows milk is needed more than ever,

Yours Sincerely

M<sup>r</sup> A Waghorn



Port Stanley  
24/6/28.

The Honourable,  
The Colonial Secretary.

Sir,

In reply to your invitation to Cattle Owners for suggestions re. The dividing of the Common into three sections - East & West ends for dry cattle & horses, centre for cart-horses & milk cows.

I think this would be a very good scheme, if the East portion included the Peninsula, & the West portion Mullet Creek. By the proposed arrangement it means starvation for the dry animals & cows for the cart-horses etc. Why the latter should be given preference over riding horses, I fail to understand. It suggests outside influence was the one responsible for these alterations.

I had always been of the opinion that the Common was for the benefit of the public in general not for a few favoured individuals.



The fact of the matter is, the Common, is too small to carry the number of animals on it at present. There are two alternatives, a larger Common, or reduce the quantity of stock.

If neither of these is practicable, then the Common is best left as it is.

If your proposed alterations are forced on the owners of dry cattle, I would like to suggest that you omit the word Grazing on the licence.

I have the honour to be,  
Sir,

Your obedient servant  
H. Dettleff.



Stanley

June 1928

Sir,

I have seen a government Notice dated April 24<sup>th</sup> 1928. Asking opinions about shifting the dry cattle on the common from the centre part, some to the East part and some to the West part. And to keep the Milk cows and cart horses in the centre part. I am of opinion that it would over crowd the East and West parts as the bulk of the animals would be there, and the centre would only benefit a few carters. My cows feed at the East end of the common and when they are up milking if I put them in the centre part they would only roam along the fence and the feeding I gave them when they came home would be very little good. And when they went dry I would have to put them back on the East end of the common to starve, ~~so~~<sup>as</sup> it would be cropped bare by the dry animals and 60 or 50 riding horses that would be put there in the summer as riding is the only pleasure we get here in summer time.

I think it would be better if the



animals could roam about, they would find better shelter and feeding.

I have the honour to be

Sir

Your Obedient Servant

F. G. Berntsen



Stanley  
June 26  
1928

Sir

With reference to Notice concerning  
division of common I beg to  
offer a few opinions.

That any animals drifted  
from their usual feeding ground  
would hang to the fences and  
most probably starve.

Milk cows going dry would be  
turned into the already heavily  
stocked ends of the common and  
it would be impossible for them  
to rear a decent calf.

The popular recreation of  
horse riding would be greatly  
handicapped & debarrred from  
many owing to the fact that  
horses would have to be

hand fed at a very high cost,  
as the sections allotted to horses



would not support them in the summer owing to the large number of dry animals grazing on them they would have no opportunity of recovering in the spring.

That all animals grazing on the common should be at liberty to feed where they wish, as at present, would in my opinion be more beneficial to the community than the proposed alterations, unless a further piece of ground could be found for the dry animals.

I am

Your obedient servant

Albert Lillman

The  
Colonial Secretary  
Stanley



Stanley.

26<sup>th</sup> June 1928.

Sir,

With reference to the notice recently published in the "Penguin" re the Proposed Division of the Common, I am of the opinion that the scheme is impracticable.

The centre portion would have to carry only a very few cows, and cart horses are practically all hand fed and are seldom let loose on the common but kept stabled for convenience.

The east & west portions would therefore have to carry the remaining cows as well as some 150 riding horses. This, I think, would prove fatal to the cows and horses in question.

The results would be that the centre part would be understocked and the end parts overstocked to an unheard of degree. The dry cattle would starve as no one can afford to feed them by hand. Horses could not be let run during the week on the common and few people can afford to feed them solely by hand. The popular pastime of horse riding would practically cease to exist.



The advantages resulting from such  
divisioning, would, I fear, be only in the  
negative.

I am,  
Sir,  
Your obedient servant

Karl V Hellman

CROXLEY MANIFEST BANK

LONDON

The Hon.  
The Col. Secretary,  
Stanley.



35

Stanley, Falkland Islands.

June 28th. 1928.

Sir,

I beg to offer my opinion on the divisional Common fence. In my opinion it is of no material use or benefit to any one keeping Cows for the purpose of the milk supply of the Town.

If the Cows have to be put in the centre section while milking, they will have to be taken away from their usual feeding ground, and naturally <sup>they will</sup> hang the fence trying to get back to ~~their~~ usual feed, all the hand feeding will thus be wasted as regards to increase of milk supply. Further I dont consider their will be sufficent food for them when confined in such a small space.

I am,

Sir,

Your obedient servant,

The Honourable Colonial Secretary.

Stanley, F.I.

*D. Biggs.*



Stanley, Falkland Islands.

June 28th. 1928.

Sir,

I beg to offer my opinion on the divisional Common fence. In my opinion it is of no material use or benefit to any one keeping Cows, for the purpose of the milk supply of the Town.

If the Cows have to be put in the centre section while milking, they will have to be taken away from their usual feeding ground, and naturally <sup>they will</sup> hang the fence trying to get back to ~~their~~ usual feed, all the hand feeding will thus be wasted, as regards to increase of milk supply. Further I dont consider their will be sufficient food for them when confined in such a small space.

I am,

Sir,

Your obedient servant,

The Honourable Colonial Secretary.

Stanley, F.I.

*H. Clifton*



Fort Stanley  
29/6/28

Sir

Referring to your notice regarding the centre portion of the common, I do not see that it would be at all beneficial to anyone - to use this part for cart horses & milk cows only. Considering the fact that the cart horses are working in town during the day, & that the vast majority of milk cows "hang" the common fence from morning till evening, I maintain that the said piece of land would practically be lying idle.

I am

Yours. respectfully

R. Reibe

H. Jennings

C 11  
12 1  
10 1  
5 2  
5 3  
3



Stanley.

30<sup>th</sup> June.

134

To The Hon. The Colonial Secretary,

Sir,

With reference to the Government notice in the "Penguin" April 24<sup>th</sup> in which was stated the proposed arrangement regarding the grazing of animals on the Stanley Common, I feel that I must strongly advise the authorities to refrain from taking steps which will be so detrimental to all animal owners. The proposal simply amounts to this. The largest and best grazing of the three sections would be occupied by roughly 10% of the stock, the remaining animals to be kept in the other two sections.

As the common, without any division fences is already inadequate for the amount of stock grazing on it, there is no need to dwell on the result of penning up



90% of the stock in about 50% of the grazing ground. The cows actually in milk would benefit for a time, but as they in turn become dry, so they and their calves must be put into sections which must in a very short time become animal cemeteries.

The idea of a separate piece of ground for all dry and young animals is sound as was seen by the two years the Stanley cattle were sent to Anson, but the Common, already so overstocked has not that ground to spare. Therefore I suggest that if nothing more beneficial than the present suggestion can be offered to the public, the Common is better left undivided.

I am

your obedient servant  
Thos Dettleff

---



41

Stanley,

29th June, 1928.

Sir,

With reference to your notice published on the 17th of April, 1928, regarding the proposed alteration of the grazing conditions of the Stanley Common, we, the undersigned beg to state that we are not in agreement with the proposals made.

In the first place we would point out that the number of cows actually in milk and the number of horses used for draught work is a very small percentage of the number of cattle and horses grazed on the Stanley Common, (in fact on the central section alone), therefore if all animals other than those above mentioned are turned into the east and west sections, which are certainly much inferior for grazing purposes than the central section, they would no doubt hang the fence and eventually die of starvation.

Furthermore we would state that draught

horses/

The Honourable  
The Colonial Secretary,  
STANLEY.



are worked during the day and in many cases stabled during the night, so in this respect the central portion of the Common would be wasted.

We are, Sir,

Yours respectfully,

*W. Aldridge*  
*W. Aldridge*

*J. Aldridge.*

*A. Petterson Jun.*

*Joseph Aldridge*



GOVERNMENT NOTICE.

No. 175.

Colonial Secretary's Office,  
Stanley, Falkland Islands.

23rd July, 1928.

The Acting Governor desires to call attention to Government Notice No. 123 of the 17th of April, 1928, inviting any person interested to submit his or her views in regard to the proposed arrangement for the division of the grazing on the Common at Stanley into three sections for use as therein explained, and to say that His Excellency is grateful for the many letters addressed to the Colonial Secretary on this subject which have proved without exception to be both of interest and of assistance in considering the matter in question.

His Excellency wishes to state, for public information, that by reason of the diversity of opinion shown in the letters received it is not proposed at any rate for the present to take any step in this matter in alteration of the existing practice, and that in any case if and when such alteration is again contemplated at some future date ample notification will be given beforehand to all concerned.

By Command,

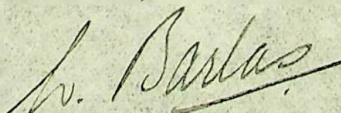

For Colonial Secretary.



43



STANLEY.

16th. November 1928.



Sir,

I have the honour to submit the following report on the cattle on the Common.

With the assistance of two men I mustered the cattle and horses yesterday. The numbers were as follows:-

149
5
55
8
—
217
57
—
268

Cows.	Calves.	Yearlings.	Bulls.	Horses.
149 /	5 /	55 /	8 /	51 /

A large number of the cows are very old and in poor condition and I consider it would be kindness to destroy them as they will in all probability die this winter.

The yearlings include six bullock.

The bulls are of all ages 4 of them yearlings. One Black Pole Angus bull has, I am informed, been on the Common for at least five years, which means that he is at present undoubtedly serving his own progeny, I would here mention that many of the yearlings are very small.

The Chief Constable informs me that there are still a great many more horses to come in and I would suggest that they be put on the West End section as there is more feed there than on the other two sections and very few animals.

In conclusion I would remark that 65 animals died of starvation on the common last winter.

I am

Sir,

Your obedient servant.

*W. Faithful.*

THE HONOURABLE  
THE COLONIAL SECRETARY  
STANLEY.



List of Animals licenced to graze on the Common.  
 for the year 1928

(1)

Name	No. of licence	£	Fee Paid			
			s	d.		
Mrs Browning	390	-	3	0	2 cows	1 month
L. Bonner	391	-	1	6	1 horse	1 " "
Mrs C. Graddell	392	-	10	0	1 cow.	1 year
A. P. Hardy	393	-	9	0	6 horses	1 month
A. Bonner	394	-	1	6	1 horse	1 month
H Delleff	395	1	0	0	2 cows	1 year.
A. Clarke	396	-	10	0	1 horse	1 year
B. Sedgwick	397	-	15	0	1 cow, yearling	1 year
F King	398	-	10	0	1 cow.	1 year
J. Clarke	399	-	10	0	1 cow	1 year
J. Clarke	400	-	3	0	2 horses	1 month
R. Smith	401	-	1	6	1 horse	1 month
D. Biggs	402	2	10	0	5 cows.	1 year
W. A. H. Biggs	403	-	10	0	1 horse	1 year
G. Martin	404	-	5	0	1 horse	season
F Bernstein	405	3	0	0	5 cows 2 yearlings	1 year
Mrs McDaid	406	2	0	0	4 cows	1 year
J. Smith	407	1	15	0	3 cows 1 yearling	1 year
J. Smith	408	-	4	6	1 horse	3 months
H Clifton	409	-	10	0	1 cow	1 year
A. Kiddle	410	-	10	0	1 cow	1 year
Mr. Pauline	411	-	3	0	2 horses	1 month
D. Short	412	1	10	0	3 cows	1 year.
D. Short	413	-	9	0	2 horses	3 months
J. P. Walker	414	1	10	0	2 cows 2 yearlings	1 year
G. H. Clarke	415	1	15	0	3 cows 1 yearling	1 year
R. Robson	416	-	4	6	1 horse	3 months.
A. Pettersen <sup>jun</sup>	417	-	10	0	1 cow	1 year
A. Pettersen <sup>sen</sup>	418	-	9	0	2 horses	3 months

Cows 36  
 yearlings 7  
 horses 22.



List of Animals licensed to graze on the Common  
for the year 1928

(4)

Name	No of Licence	Fee Paid				
		£	s	d		
R. Smith	491	-	3	0	2 horses	1 month
Mrs Browning	493	-	1	6	1 cow	1 month
A. Halliday	495	-	9	0	6 horses	1 month
W. R. Flowers	496	1	16	0	24 horses	1 month
L. Bonner	497	-	1	6	1 horse	1 month
G. Hansen	500	-	1	6	1 horse	1 month
J. F. Summers	502	1	0	0	1 cow 1 horse	1 year.
S. Barnes	503	-	1	6	1 horse	1 month
P. Biggs	504	-	1	6	1 horse	1 month
Mrs Browning	506	-	3	0	2 cows	1 month
L. Bonner	507	-	1	6	1 horse	1 month
A. Biggs	508	-	1	6	1 horse	1 month
W. Nielsen	509	-	1	6	1 horse	1 month
Mrs Waghorn	510	-	1	6	1 cow.	1 month
Clifton	511	-	1	6	1 cow	1 month
F. May	512	-	3	0	2 horses	1 month
Mrs Browning	513	-	1	6	1 cow	1 month
L. Henriksen	514	-	1	6	1 horse	1 month
A. Barnes	515	-	1	6	1 horse	1 month
S. Kiddle	516	-	1	6	1 horse	1 month
W. Summers	517	-	3	0	2 cows	1 month
Mrs Waghorn	518	-	1	6	1 cow	1 month
E. Biggs	519	-	5	0	1 cow	6 months
S. H. Hooley	520	-	1	6	1 horse	1 month
J. Goss	521	-	1	6	1 horse	1 month
E. G. Rowe	522	-	1	6	1 horse	1 month
G. Lanning	523	-	3	0	2 horses	1 month
B. Dixon	524	-	1	6	1 horse	1 month
H. Clifton	525	-	3	0	2 yearlings	1 month
L. Bonner	526	-	1	6	1 cow	1 month
W. Goss	527	-	1	6	1 horse	1 month
W. Nielsen	528	-	1	6	1 horse	1 month
F. Binnie	529	-	4	6	1 horse	3 months

Cows      Yearlings      Horses.  
12.                  2.                  54



List of animals licenced to graze on the common.  
for the year 1928

(2)

Name	No of Licence	Fee Paid				
		£	s	d		
R. Reeves	419	-	1	6	1 horse	1 month
J. Pittersen	420	-	4	6	1 horse	3 months
C. Lehen	421	2	5	0	3 cows, 1 horse 1 yearling	6 years
L. Sellmann	422	-	1	6	1 horse	1 month
L. Bonner	423	-	1	6	1 horse	1 month
L. Howe	424	-	1	6	1 horse	1 month
D. Lees	425	1	0	0	2 cows	1 year
J. Sellmann	426	-	10	0	1 cow	1 year
S. H. Hooley	427	-	15	0	1 cow, yearling	1 year
S. H. Hooley	428	-	3	0	1 horse	2 months
W. Watson	429	1	0	0	2 cows	1 year.
H. Summers	430	-	10	0	1 horse	1 year.
F. Summers	431	1	0	0	2 horses, 1 yearling	1 year. 1 year.
A. Porter	432	-	5	0	2 cows	1 year.
D. Lehen	433	1	0	0	1 yearling	1 year.
Mrs Braxton	434	4	10	0	2 cows	1 year.
Mrs Braxton	435	1	0	0	9 cows	1 year.
R. Atkins	436	1	15	0	2 cows	1 year.
D. Atkins	437	-	3	0	3 cows 1 yearling	1 year.
Mrs Sedgwick	438	1	5	0	1 horse	2 months
M. Dettleff	439	6	0	0	2 cows 1 yearling	1 year.
J. Miller	440	5	15	0	10 cows 4 yearlings	1 year.
M. Johnston	441	1	0	0	8 cows 3 yearlings 2 horses	1 year.
P. Hills	442	1	5	0	1 cow 1 horse	1 year.
L. Dettleff	443	1	0	0	2 cows 1 yearling	1 year.
A. Kiddle	444	-	4	6	2 cows	1 year.
D. Lees	445	-	1	6	1 cow	3 months
L. F. Thompson	446	-	10	0	1 horse	1 month
M. Steel	447	3	15	0	1 cow	1 year.
Mrs J. Davis	448	6	10	0	6 cows 3 yearlings	1 year.
J. Davis	449	-	9	0	13 cows	1 year.
M. Dettleff	450	-	1	6	2 cows	3 months
					1 cow	1 month

cows yearlings  
74 16

Horses  
15



List of animals licensed to graze on the Common  
for the year 1928

(5)

Name	No of Licence	Fee Paid				
		£	s	d		
W. Goss	530	-	1	6	1 horse	
J. O'Shane	542	-	5	0	1 horse	1 month
Mrs. Bartram	543	-	4	6	1 horse	Season.
S. Gladell	544	-	1	6	1 Cow	3 months
J. Smith	545	-	5	0	1 horse	1 month
J. Glaske	546	-	1	6	1 horse	Season.
S. Barnes	547	-	5	0	1 horse	1 month
W. Goss Jun	548	-	1	6	1 horse	Season.
J. Barnes	549	-	1	6	1 horse	1 month
W. Morrison	550	-	1	6	1 horse	1 month
J. Dettleff	551	-	15	0	3 horses	1 month
E. Martin	552	-	15	0	3 horses	Season.
J. Hardy	553	-	10	0	3 horses	Season.
F. Hardy	554	-	5	0	2 horses	Season.
M. Gladell	555	-	5	0	1 horse	Season
S. Gladell	556	-	5	0	1 horse	Season.
S. Bonner	557	-	4	6	1 horse	Season.
A. Bonner	558	-	15	0	3 horses	1 month
S. Kiddle	559	-	10	0	3 horses	Season
J. Clarke	560	-	3	0	2 horses	Season.
A.P. Hardy	561	-	10	0	2 horses	1 month
L. Hansen	562	-	5	0	2 horses	Season.
S. Bonner	563	-	1	6	1 horse	Season
L. Lanning	564	-	5	0	1 horse	1 month
J. Dettleff	565	-	10	0	1 horse	Season
L. Aldridge	566	-	5	0	2 horses	Season.
W. Bonner	567	-	5	0	1 horse	Season.
S. Summers	568	-	5	0	1 horse	Season.
J. Campbell	569	-	10	0	1 horse	Season.
E. Dettleff	570	-	15	0	2 horses	Season.
M. Creech	571	-	10	0	3 horses	Season
B. Dixon	572	-	5	0	2 horses	Season
F. O'Sullivan	573	-	5	0	1 horse	Season.
S.H. Hooley	574	-	1	6	1 horse	1 month
A. Still	575	-	3	0	2 horses	1 month
L. Bonner	576	-	3	0	1 horse 1 Cow	1 month
L. Reeves	577	-	5	0	1 horse	Season.

Cows  
2.

Yearlings  
←

Horses  
54



List of animals licensed to graze on the Common  
for the Year 1928

(3)

Name	No of Licence	Fee Paid				
		£	s	d		
J Binnie	451	-	5	0	1 horse.	season.
B. Fleuret	452	-	3	0	2 horses	1 month
D. Fleuret	453	-	1	6	1 horse	1 month
J Mc Gill	454	6	10	0	10 cows 2 yearlings 2 horses	1 year.
W. Sedgwick	455	1	0	0	2 cows.	1 year.
J. Short	456	4	5	0	7 cows 3 yearlings	1 year.
V. McLeod.	457	-	4	6	1 cow.	3 months
L Hardy	458	-	10	0	1 cow.	1 year.
J. W. Phee	459	-	10	0	1 cow	1 year.
W. Hutchinson	460	7.	5	0	12 cows 1 yearling 2 horses	1 year.
W. Hutchinson	461	-	9	0	2 horses	3 months
G. Perry	462	3	0	0	5 cows 2 yearlings	1 year.
G. Perry	463	-	3	0	2 horses	1 month
J Skillings	464	5	10	0	9 cows 2 horses	1 year.
S. Sutton	465	-	9	0	2 horses	3 months
J Mc Vicoll	466	1	5	0	2 cows 1 yearling	1 year.
Mrs H. Williams	467	5	0	0	10 cows	1 year.
J Miller	468	2	0	0	4 cows	1 year.
S Barnes	469	-	3	0	2 horses	1 month
J. Goes	470	-	1	6	1 horse	1 month
Mrs Summers	471	-	3	0	2 horses	1 month
Mrs Browning	472	-	3	0	2 cows	1 month
J Clarke	473	-	1	6	1 horse	1 month
L Bonner	474	-	1	6	1 horse	1 month
D Morrison	475	-	1	6	1 horse	1 month
H Pauline	476	-	3	0	1 horse	2 months
M. Carey	482	-	3	0	1 horse	2 months
Mrs Browning	483	-	1	6	1 cow.	1 month
J Hardy	484	-	10	0	1 horse	1 year.
J Hardy	485	-	3	0	1 horse	2 months
G R L Brown	486	-	6	0	2 horses	2 months
Mr Burns	489	-	1	6	1 horse	1 month
J. Clarke	490	-	1	6	1 horse	1 month

cows yearlings Horses.  
67. 9. 32.



List of Animals licenced to graze on the Common  
for the year 1928.

(6)

Name	No of Licence	Fee Paid				
		£	s	d		
A Bonner	578	-	1	6	1 horse	1 month
S Linton	579	-	10	0	2 horses	season
L. Clithro	580	-	5	0	1 horse	Season
J Clithro	581	-	3	0	2 horses	1 month
Mj Carey	582	-	5	0	1 horse	Season.
S N Woolley	583	-	1	6	1 horse	1 month
C. W Carey	584	-	5	0	1 horse	Season
A P. Hardy	585	-	15	0	3 horses	Season
J. Jennings	586	-	4	6	1 horse	3 months

J. C. Sullivan  
Chy Constat

5-12-28

The above figures may be  
summarised as follows on an  
annual month basis.

Cows	Yearlings	Horses	Annual months
2051	386	712	
171	32 1/2	59 1/3	Animals p yr.

Total 262 1/2 animals per year.

which compares reasonably with the  
number numbered 15/11/28. (Red 43.)

24/4/45





Stock Department,  
Stanley.

30/9/29

Sir,  
I beg to submit the following observations on the Common Grazings.

The yearly licences total 179, 140 cows 25 yearlings and 14 horses, but to this number must be added the short period licences, average figures for these are cows by month 32, horses for 3 months 78. During the month of July only 30 per cent of the cows were yielding milk. This figure is low even for mid Winter and indicates that many useless animals are being grazed on the common.

During the past six weeks several animals have died. Such losses are certain to occur when animals are out wintered without much supplementary feeding. The death rate does not warrant removal to Tussac as in 1928. Indeed with milk retailed at 3/- - 4/- per gallon and grazing for the year costing only 10/- per cow the owners ought to be prepared to feed during the hard months of the year.

When facilities for Bacteriological examination of milk under the Public Health Ordinance are obtained poor animals will be weeded out, but as long as grazing can be obtained for 10/- per year useless animals will run on the Common.

In order to prevent increase, I beg to suggest that

- I. The number of licences be limited.
- or
- 2. The cost of licences be increased to a figure which will necessitate disposal of "scrubs".

I have the honour to be  
Your obedient servant,

Veterinary Officer.

Hon Col. Secy.  
Port Stanley.



EXTRACT FROM THE COLONIAL ENGINEER'S MINUTE OF 18th OCTOBER 1929.

FILED IN M.P. 378/27.

.....

On an inspection of fences last week it was found that the fence erected for the purpose of dividing the Common had been cut ~~two~~ through in no less than 13 places.

2. One gate has been taken away and cannot be found whilst another gate has been removed from its hinges.

.....



Stanley.  
 Falkland Islands,  
 Dec 2<sup>nd</sup> 1929

The Hon.  
 G. Roberts, Esq.  
 Colonial Engineer.  
 Stanley.

Sir,  
 I hereby make an offer of £4.  
 for the purchase from the Government of  
 Part of Division 7 fence, (Common) approximately  
 200 yards, situate to north of Mrs Dettleff's  
 Paddock.

I also agree to remove fence & fill in holes  
 & leave site tidy.

I am,  
 Sir,  
 Your Obedient Servant,  
 John W. Luckey.



50

No.

MINUTE.

(It is requested that, in any reference to this minute, the above Number and the date may be quoted).

6th December, 1929

From Colonial Engineer.

To

THE COLONIAL SECRETARY,

Stanley, Falkland Islands.

M.P. 709/24.

Common - Grazing Areas.

With reference to the invitation to tender for the purchase and removal of the Common fence running from Mr. Dettleff's paddock Southerly to Eliza Cove, I beg to report that no offers have been received.

2. An offer has, however, been received from Mr. J.D.Mc.Kay for the section of the Common fence to the North of Mr. Dettleff's paddock, for £4, as attached letter. This is really a continuation of the fence which was offered for sale and comprises only 300 yards.

3. I think that the offer is fair and reasonable and submit that it may be accepted.

*C. Roberts*

Colonial Engineer.



Stanley.

3-2-30

The Colonial Engineer  
Stanley.

Dear Sir

I wish to offer £60.00 for the  
Common Fence which was recently put up for tender &  
which has to be pulled down & removed.

Yours Faithfully  
for C. Bender.

b. p. w. at any



No. \_\_\_\_\_  
(It is requested that, in any reference to this minute, the above Number and the date may be quoted).

MINUTE.

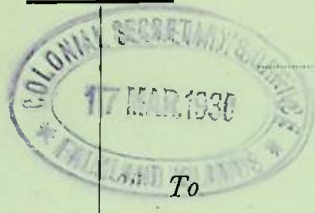

17th March, 19 30.

From Colonial Engineer.  
\_\_\_\_\_  
\_\_\_\_\_

To

THE COLONIAL SECRETARY,  
  
Stanley, Falkland Islands.

M.P. 709/24.

Submitted for approval to accept the attached offer for the purchase of the Common fence running from Mr. Dettleff's paddock to Eliza Cove, which it was recently approved to dispose of.

Invitation to tender was inserted in "Penguin" in November, 1929, but no offers were received by the date stated.

Endeavours have been made to obtain a higher price but without success, and the longer the fence lays the more it deteriorates.

*C. Roberts,*  
Colonial Engineer.